

Ownership	Acres	Percent
U.S. Forest Service	83,053	60.2
Private Industry Land	39,081	28.3
Bureau of Land Management	12,592	9.1
Private Rural Lands	2,879	2.1
Local Government	262	0.2
State Agency	112	<0.1
State Dept. of Forestry	40	<0.1

Riverside Incident Ownership
ORMHF-000859
Day Operational Period 9/22/2020

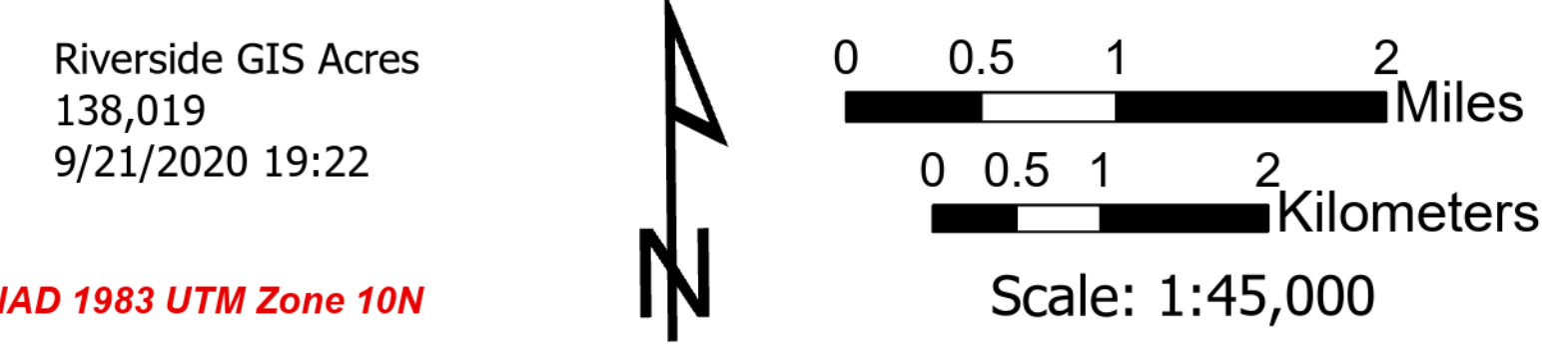

- ▬ Event Polygon
- Administrative Forest
- Wilderness
- Bureau of Land Management
- U.S. Fish and Wildlife Service
- Local Government
- State Agency
- State Dept. of Forestry
- State Dept. of Parks and Recreation
- U.S. Forest Service
- Private Rural Lands
- Private Industry Lands



Map Created 9/22/2020 by [unreadable]