

# Incident Action Plan

## Colfax Complex

WA-WFS-114 Manning

WA-WFS-116 Malden/Babb

WA-NES-2151

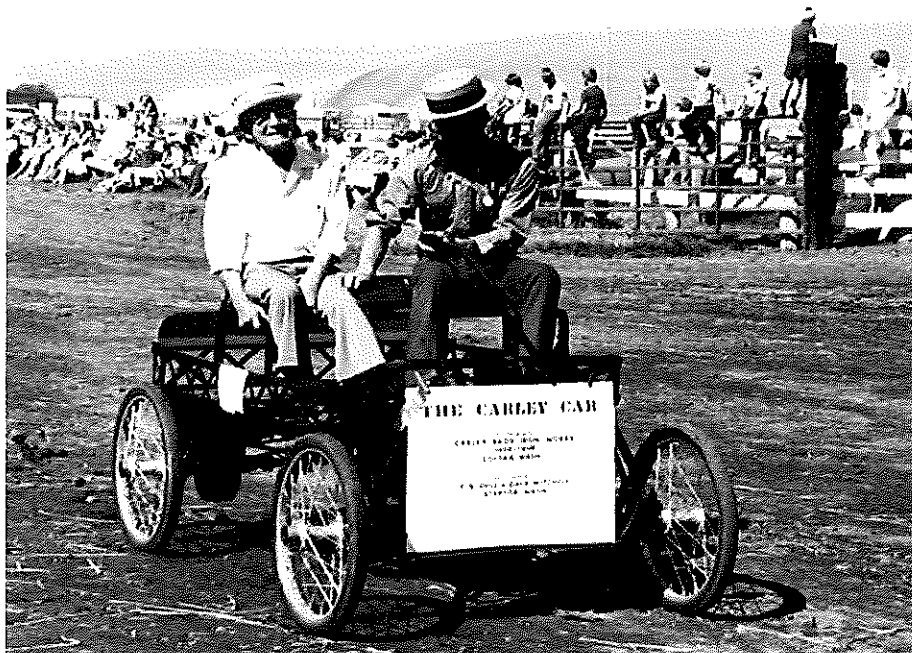

Built in Colfax, the Carley Car was the first automobile in Washington State. The car made it's debut on July 4, 1900

Operation Period: 0600 - 0600



September 10, 2020



Pay Codes/WA-WFS-116

221 - AKV

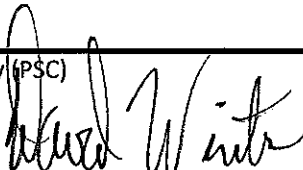
221 - BPP (FMAG)

<b>Incident Objectives</b>	1. Incident Name <b>Colfax Complex</b>	2. Date Prepared <b>9/9/2020</b>	3. Time Prepared <b>1207</b>									
4. Operational Period (Date and Time) <b>9/10/2020 24hr (0600-0600)</b>												
5. General Control Objectives for the Incident (include Alternatives) <ul style="list-style-type: none"> <li>• Provide for firefighter and public safety at all times. This includes the application of the "10 and 18", LCES, and the Risk Management Process.</li> <li>• Maximize opportunity for cost saving without jeopardizing public or firefighter safety.</li> <li>• Maintain awareness of avoidance areas and implement tactics accordingly.</li> <li>• Act professionally and in a manner that fosters good relationships with the public, private landowners, timber industry representatives, elected officials and other stakeholders.</li> <li>• Maintain best management practices to limit the spread and exposure of the COVID-19 virus within the crew, on the line, in camp, and to the surrounding community.</li> </ul>												
6. Weather Forecast for Operational Period  See attached weather forecast.												
7. General Safety Message <ul style="list-style-type: none"> <li>• Provide for firefighter and public safety at all times.</li> <li>• Monitor compliance of 10 and 18 by all incident personnel.</li> <li>• Adhere to 2:1 work/rest ratio for all fire line personnel.</li> <li>• Aviation safety is high priority. Assess the risk against the benefit of the mission.</li> <li>• Ensure all assigned personnel understand emergency medical reporting &amp; transport procedures including locations of nearest emergency responders &amp; facilities.</li> </ul>												
8. Attachments (check if attached) <table border="0" style="width: 100%;"> <tr> <td><input checked="" type="checkbox"/> Organization List (ICS 203)</td> <td><input checked="" type="checkbox"/> Assignment List (ICS 204)</td> <td><input type="checkbox"/> Air Operations (ICS 220)</td> </tr> <tr> <td><input checked="" type="checkbox"/> Weather</td> <td><input checked="" type="checkbox"/> Communication Plan (ICS 205)</td> <td><input checked="" type="checkbox"/> HR Message</td> </tr> <tr> <td><input checked="" type="checkbox"/> Safety Message</td> <td><input checked="" type="checkbox"/> Medical Plan (ICS 206)</td> <td><input checked="" type="checkbox"/> Incident Maps</td> </tr> </table>				<input checked="" type="checkbox"/> Organization List (ICS 203)	<input checked="" type="checkbox"/> Assignment List (ICS 204)	<input type="checkbox"/> Air Operations (ICS 220)	<input checked="" type="checkbox"/> Weather	<input checked="" type="checkbox"/> Communication Plan (ICS 205)	<input checked="" type="checkbox"/> HR Message	<input checked="" type="checkbox"/> Safety Message	<input checked="" type="checkbox"/> Medical Plan (ICS 206)	<input checked="" type="checkbox"/> Incident Maps
<input checked="" type="checkbox"/> Organization List (ICS 203)	<input checked="" type="checkbox"/> Assignment List (ICS 204)	<input type="checkbox"/> Air Operations (ICS 220)										
<input checked="" type="checkbox"/> Weather	<input checked="" type="checkbox"/> Communication Plan (ICS 205)	<input checked="" type="checkbox"/> HR Message										
<input checked="" type="checkbox"/> Safety Message	<input checked="" type="checkbox"/> Medical Plan (ICS 206)	<input checked="" type="checkbox"/> Incident Maps										
ICS-202	9. Prepared by (PSC) David Winter 		10. Approved by (IC) Bob Gear 									

<b>ORGANIZATION ASSIGNMENT LIST</b>			
1. Incident Name <b>Colfax Complex</b>		<b>9. OPERATIONS SECTION</b>	
2. Date 9/10/2020	3. Time 1200	Chief	Rich Elliott 509.201.6280
4. Operational Period 0600-0600		Deputy/ Night Ops	Ryan Cloud 509.528.6196
<b>5. INCIDENT COMMANDER &amp; STAFF</b>		<b>a. Division-Malden North</b>	
Incident Commander	Bob Gear 509.528.1650	Division Supervisor	Rusty Bachman 509.492.0061
Deputy		Deputy	
Safety Officer	Mark Knokey 509.869.3624	Division/Group	
Information Officer	Sydney McBride 206.459.5081	Division/Group	
		<b>b. Division-Malden South</b>	
		Division Supervisor	Brandon Burton 509.760.0101
		Deputy	
<b>6. AGENCY REPRESENTATIVE</b>		Division/Group	
Agency	Name	Division/Group	
WSFMO	Cathy Sablan 360.280.1223	<b>c. Division-Manning</b>	
		Division Supervisor	Mike Emerick 509.531.7193
		Deputy	
		Division/Group	
		Division/Group	
		<b>d. Division-Colfax</b>	
<b>7. PLANNING SECTION</b>		Division Supervisor	Tim Tingley 509.432.1661
Chief	David Winter 509.301.2631	Deputy	
Deputy	Fred Knowles 509.386.3406	Division/Group	
SCKN	Bill Box 509.540.1686	Division/Group	
SCKN (T)	Brian Dodge 360.870.6700	<b>e. Air Operations</b>	
Documentation Unit		Air Ops Branch Director	
Demobilization Unit		Air Support Supervisor	
Human Resources		Air Attack Supervisor	
Technical Specialist (Name/Specialty)		Helicopter Coordinator	
		Air Tanker Coordinator	
		<b>10. FINANCE SECTION</b>	
		Chief	Bob Thompson 509.531.4842
<b>8. LOGISTICS SECTION</b>		Deputy	Slita Bradley 719.406.2772
Chief	Whitman Spencer 509.724.3251	Time Unit	
Deputy	Maryam Majidian 509.859.1009	Procurement Unit	
Supply Unit	Kevin Sell 509.521.0670	Cost Unit	
Facilities Unit		<b>11. CONTACTS / OTHER INFORMATION</b>	
Ground Support Unit		NWICC 509.685.6900	
Communications Unit			
Medical Unit			
Security Unit		Prepared by (Resource Unit Leader)	
Food Unit		Fred Knowles 	

# IT'S HOT



**HYDRATE!**

# STAY

# SAFE

SafetyBanners .ORG

# Spot Weather Forecast

Colfax Complex 9/10/2020 Operational Period: 24hr

## DISCUSSION...

Dry conditions will persist through the weekend as temperatures warm up to the upper 80s. Winds will be light out of the east early Thursday but will turn south and then southwesterly during the afternoon. With hot afternoon temperatures and dry conditions, minimum daytime relative humidity will drop down to the mid-teens Thursday and Friday with only moderate recoveries overnight to the about 50 percent.

## THURSDAY...

Sky/weather.....Sunny.  
CWR.....0 percent.  
LAL.....1.  
Max temperature.....Around 87.  
Min humidity.....14 percent.  
Wind (20 ft).....East winds 3 to 5 mph in the morning shifting  
to the southwest 3 to 6 mph around 1300.  
Mixing height.....3500 ft AGL in the morning increasing to 6000  
ft AGL in the afternoon.  
Transport winds.....South around 6 mph.  
Haines Index.....5 or moderate potential for large plume  
dominated fire growth.

## THURSDAY NIGHT...

Sky/weather.....Clear.  
CWR.....0 percent.  
LAL.....1.  
Min temperature.....Around 48.  
Max humidity.....49 percent.  
Wind (20 ft).....West winds 3 to 5 mph in the evening becoming  
light overnight.  
Mixing height.....3500 ft AGL in the evening decreasing to near  
the surface overnight.  
Transport winds.....Southeast around 4 mph.  
Haines Index.....5 or moderate potential for large plume  
dominated fire growth.

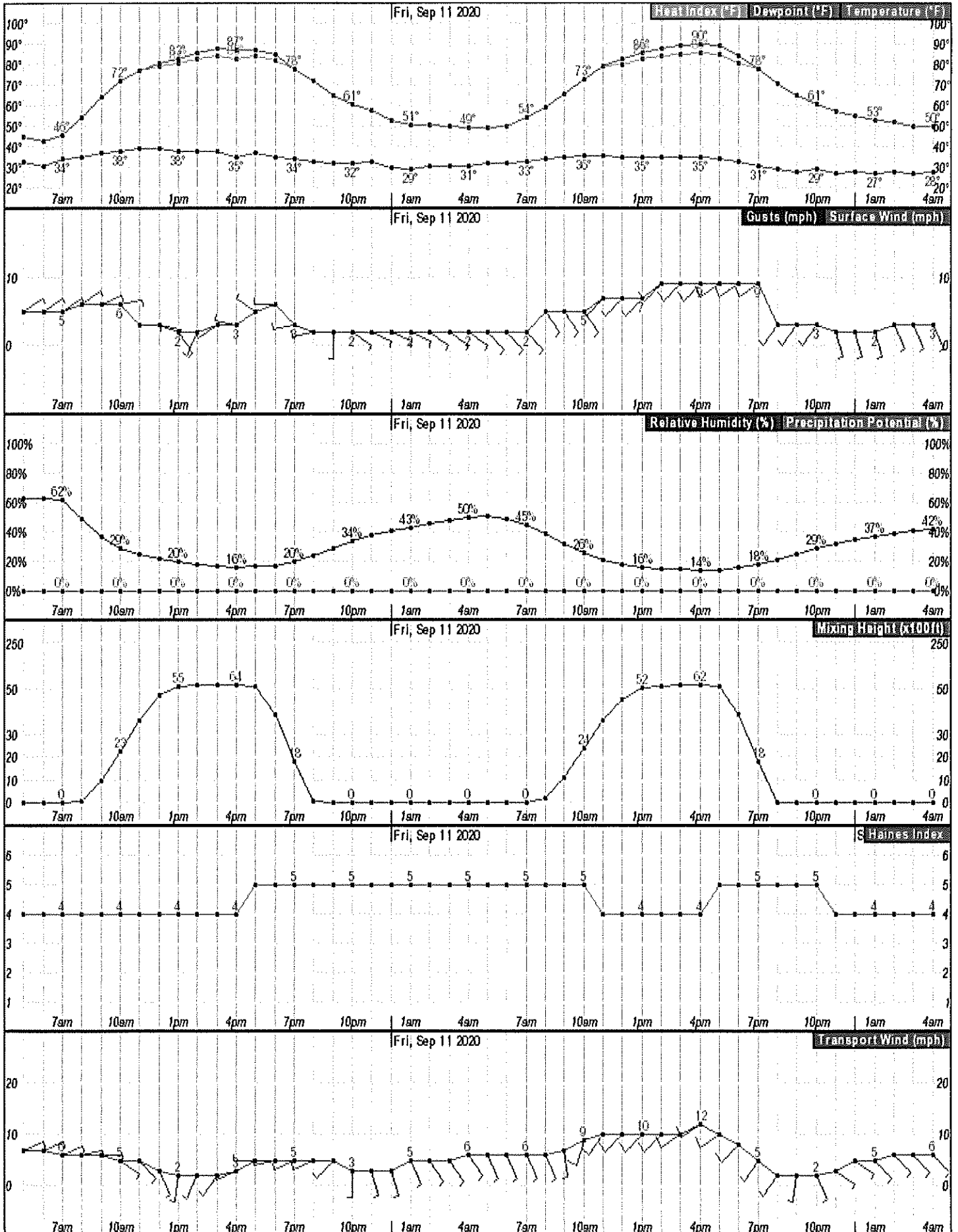

Weather Chart provided by Brian Dodge.

<b>DIVISION ASSIGNMENT LIST</b>			1. Branch		2. Division / Group <b>Malden North</b>	
3. Incident Name <b>Colfax Complex</b>			4. Operational Period Date: <b>9/10/2020</b> Time: <b>0600 - 1800</b>			
<b>5. Operations Personnel</b>						
Operations Chief		<i>Rich Elliott 509.201.6280</i>		Branch Director		
Safety Officer		<i>Mark Knokey 509.869.3624</i>		Division/Group Supervisor		<i>Rusty Bachman 509.492.0061</i>
<b>6. Resources Assigned this Period</b>						
RO #	Strike Team/Task Force/Resource	Leader	# People	Contact (phone, radio freq, etc.)	EMT	Remarks
	North East WL ST				<input type="checkbox"/>	
	STL	Gillaspy	1	916.752.8082	<input type="checkbox"/>	
	E-2110		3		<input type="checkbox"/>	
	E-2111		3		<input type="checkbox"/>	
	E-2112		3		<input type="checkbox"/>	
	E-2113	Kimball (TFL)	3	509.863.5133	<input type="checkbox"/>	
	E-2115		1		<input type="checkbox"/>	
					<input type="checkbox"/>	
O-1	Firefly FAL MOD		2	509.563.9820	<input type="checkbox"/>	Radiox1
					<input type="checkbox"/>	
	O-2310 HEQB	Naccarato	1		<input type="checkbox"/>	
E-8	Dozer (Price)		2		<input type="checkbox"/>	
					<input type="checkbox"/>	
E-2	Med Transport	Cheeseman	2	208.869.9423	<input type="checkbox"/>	
			21			
<b>7. Work Assignments</b>						
<ul style="list-style-type: none"> <li>• Initiate structural point protection for structures that meet risk management criteria providing for firefighter safety.</li> <li>• Conduct risk assessment for potentially affected structures. Develop protection plans based upon defensible space and tactical capabilities to defend structures.</li> <li>• Conduct search and recovery efforts when safe to do so.</li> </ul>						
<b>8. Special Instructions</b>						
<b>9. Communication Summary</b>						
Function	Name	Mode	Frequency			
COMMAND	North Fire	A	RX: 154.0925 Tone 203.5 TX: 158.8725 Tone 229.1			
TACTICAL	VTAC 11	A	RX: 151.1375 Tone 156.7 TX: 151.1375 Tone 156.7			
AIR	DNR A/G 1	A	RX: 159.2700 Tone: 103.5 TX: 159.2700 Tone 103.5			
See Communication Plan ICS205 for Details						
Prepared by (RESL) Fred Knowles <i>JK</i>		Approved by (PSC) David Winter <i>David Winter</i>		Date: 9/9/2020	Time: 2130	

DIVISION ASSIGNMENT LIST		1. Branch		2. Division / Group		
				<b>Malden South</b>		
3. Incident Name			4. Operational Period			
<b>Colfax Complex</b>			Date: <b>9/10/2020</b>	Time: <b>0600 - 1800</b>		
<b>5. Operations Personnel</b>						
Operations Chief		<i>Rich Elliott 509.201.6280</i>		Branch Director		
Safety Officer		<i>Mark Knokey 509.869.3624</i>		Division/Group Supervisor <i>Brandon Burton 509.760.0101</i>		
<b>6. Resources Assigned this Period</b>						
RO #	Strike Team/Task Force/Resource	Leader	# People	Contact (phone, radio freq, etc.)	EMT	Remarks
	North East WL ST				<input type="checkbox"/>	
	STL	Jason Wilkins	1	509.370.9803	<input type="checkbox"/>	
	STL (T)	Not filled				
	E-2126		2		<input type="checkbox"/>	B-71
	E-2127		3		<input type="checkbox"/>	B-1506
	E-2128		2		<input type="checkbox"/>	B-1326
	E-2130		2		<input type="checkbox"/>	KB1
	E-2144		2		<input type="checkbox"/>	WTS2
					<input type="checkbox"/>	
O-2	Firefly FAL MOD		2	509.680.8094	<input type="checkbox"/>	Radiox1
					<input type="checkbox"/>	
E-1	Fireline Medics	Hollett	2	304.481.4069	<input type="checkbox"/>	
					<input type="checkbox"/>	
					<input type="checkbox"/>	
			16			
<b>7. Work Assignments</b>						
<ul style="list-style-type: none"> <li>• Initiate structural point protection for structures that meet risk management criteria providing for firefighter safety.</li> <li>• Conduct risk assessment for potentially affected structures. Develop protection plans based upon defensible space and tactical capabilities to defend structures.</li> <li>• Conduct search and recovery efforts when safe to do so.</li> </ul>						
<b>8. Special Instructions</b>						
<b>9. Communication Summary</b>						
Function	Name	Mode	Frequency			
COMMAND	North Fire	A	RX: 154.0925 Tone 203.5 TX: 158.8725 Tone 229.1			
TACTICAL	VTAC 14	A	RX: 159.4725 Tone 156.7 TX: 159.4725 Tone 156.7			
AIR	DNR A/G 1	A	RX: 159.2700 Tone: 103.5 TX: 159.2700 Tone 103.5			
See Communication Plan ICS205 for Details						
Prepared by (RESL)		Approved by (PSC)		Date:	Time:	
Fred Knowles <i>FJK</i>		David Winter <i>David Winter</i>		9/9/2020	2130	



DIVISION ASSIGNMENT LIST		1. Branch	2. Division / Group			
3. Incident Name <b>Colfax Complex</b>		4. Operational Period Date: <b>9/10/2020 Night</b> Time: <b>1800 - 0600</b>				
<b>5. Operations Personnel</b>						
Operations Chief	<i>Ryan Cloud 509.528.6196</i>					
Safety Officer	<i>Mark Knokey 509.869.3624</i>		Division/Group Supervisor			
<b>6. Resources Assigned this Period</b>						
RO #	Strike Team/Task Force/Resource	Leader	# People	Contact (phone, radio freq, etc.)	EMT	Remarks
	South East Structure ST				<input type="checkbox"/>	
	STL	Stubblefield	1	509.520.8268	<input checked="" type="checkbox"/>	
	E-2118	Ongers	3		<input checked="" type="checkbox"/>	WWFD E-3912
	E-2119	Nance	4		<input checked="" type="checkbox"/>	BCFD#1 E-1113
	E-2120	Peterson	3		<input checked="" type="checkbox"/>	WBFR E-1312
	E-2121	Harper	3		<input checked="" type="checkbox"/>	BCFD#4 E-1411
	E-2123	Nilsson	1		<input checked="" type="checkbox"/>	CPFD T-3021
					<input type="checkbox"/>	
					<input type="checkbox"/>	
					<input type="checkbox"/>	
					<input type="checkbox"/>	
					<input type="checkbox"/>	
					<input type="checkbox"/>	
			15		<input type="checkbox"/>	
<b>7. Work Assignments</b>						
<ul style="list-style-type: none"> <li>• Initiate structural point protection for structures that meet risk management criteria providing for firefighter safety.</li> <li>• Conduct risk assessment for potentially affected structures. Develop protection plans based upon defensible space and tactical capabilities to defend structures.</li> <li>• Strengthen established lines and provide perimeter patrol where warranted.</li> </ul>						
<b>8. Special Instructions</b>						
<b>9. Communication Summary</b>						
Function	Name	Mode	Frequency			
COMMAND	North Fire	A	RX: 154.0925 Tone 203.5 TX: 158.8725 Tone 229.1			
TACTICAL	VTAC 11	A	RX: 151.1375 Tone 156.7 TX: 151.1375 Tone 156.7			
AIR	DNR A/G 1	A	RX: 159.2700 Tone: 103.5 TX: 159.2700 Tone 103.5			
			See Communication Plan ICS205 for Details			
Prepared by (RESL) Fred Knowles <i>FK</i>		Approved by (PSC) David Winter <i>David Winter</i>		Date: 9/8/2020	Time: 2130	

DIVISION ASSIGNMENT LIST		1. Branch	2. Division / Group	Manning		
3. Incident Name <b>Colfax Complex</b>		4. Operational Period Date: <b>9/10/2020</b> Time: <b>0600 - 1800</b>				
5. Operations Personnel						
Operations Chief	<i>Rich Elliott 509.201.6280</i>		Branch Director			
Safety Officer	<i>Mark Knokey 509.869.3624</i>		Division/Group Supervisor	<i>Mike Emerick 509.531.7193</i>		
6. Resources Assigned this Period						
RO #	Strike Team/Task Force/Resource	Leader	# People	Contact (phone, radio freq, etc.)	EMT	Remarks
	Central WL ST				<input type="checkbox"/>	
	STL	Kiehn	1	206.650.6869	<input type="checkbox"/>	
	STL (T)	Sobol	1			
	E-2134		2		<input type="checkbox"/>	B-91
	E-2135		2		<input type="checkbox"/>	B-41
	E-2136		3		<input type="checkbox"/>	E-3041
	E-2137		2		<input type="checkbox"/>	E-3854
	E-2138		3		<input type="checkbox"/>	E-2366
	E-2139		2		<input type="checkbox"/>	T1-11
					<input type="checkbox"/>	
	BR-31	Pullman Fire	3		<input type="checkbox"/>	
					<input type="checkbox"/>	
					<input type="checkbox"/>	
	O-2311 EMPF	Garrelts	1		<input type="checkbox"/>	
			20			
7. Work Assignments						
<ul style="list-style-type: none"> <li>• Initiate structural point protection for structures that meet risk management criteria providing for firefighter safety.</li> <li>• Conduct risk assessment for potentially affected structures. Develop protection plans based upon defensible space and tactical capabilities to defend structures.</li> <li>• Conduct search and recovery efforts when safe to do so.</li> </ul>						
8. Special Instructions						
9. Communication Summary						
Function	Name	Mode	Frequency			
COMMAND	Colfax Fire	A	RX: 155.4000 Tone 110.9 TX: 158.9250 Tone 97.4			
TACTICAL	VTACH 13	A	RX: 158.7375 Tone 156.7 TX: 158.7375 Tone 156.7			
AIR	DNR A/G 1	A	RX: 159.2700 Tone: 103.5 TX: 159.2700 Tone 103.5			
See Communication Plan ICS205 for Details						
Prepared by (RESL)		Approved by (PSC)		Date:	Time:	
<i>SJK</i>		<i>David Wirth</i>		<i>9/9/20</i>	<i>2130</i>	

DIVISION ASSIGNMENT LIST		1. Branch	2. Division / Group	Manning Night		
3. Incident Name <b>Colfax Complex</b>		4. Operational Period Date: <b>9/10/2020 Night</b> Time: <b>1800 - 0600</b>				
<b>5. Operations Personnel</b>						
Operations Chief	<i>Ryan Cloud 509.528.6196</i>					
Safety Officer	<i>Mark Knokey 509.869.3624</i>	Division/Group Supervisor				
<b>6. Resources Assigned this Period</b>						
RO #	Strike Team/Task Force/Resource	Leader	# People	Contact (phone, radio freq, etc.)	EMT	Remarks
	Central WL ST				<input type="checkbox"/>	
	STL	Lease	1		<input type="checkbox"/>	
	STL (T)	Smith	1			
	E-2102		2		<input type="checkbox"/>	ENG6
	E-2103		3		<input type="checkbox"/>	ENG6
	E-2104		2		<input type="checkbox"/>	ENG6
	E-2105		3		<input type="checkbox"/>	ENG6
					<input type="checkbox"/>	
	E-2107		2		<input type="checkbox"/>	WTS2
					<input type="checkbox"/>	
					<input type="checkbox"/>	
					<input type="checkbox"/>	
					<input type="checkbox"/>	
			14			
<b>7. Work Assignments</b>						
<ul style="list-style-type: none"> <li>• Initiate structural point protection for structures that meet risk management criteria providing for firefighter safety.</li> <li>• Conduct risk assessment for potentially affected structures. Develop protection plans based upon defensible space and tactical capabilities to defend structures.</li> <li>• Strengthen established lines and provide perimeter patrol where warranted.</li> </ul>						
<b>8. Special Instructions</b>						
<b>9. Communication Summary</b>						
Function	Name	Mode	Frequency			
COMMAND	Colfax Fire	A	RX: 155.4000 Tone 110.9 TX: 158.9250 Tone 97.4			
TACTICAL	VTACH 13	A	RX: 158.7375 Tone 156.7 TX: 158.7375 Tone 156.7			
AIR	DNR A/G 1	A	RX: 159.2700 Tone: 103.5 TX: 159.2700 Tone 103.5			
			See Communication Plan ICS205 for Details			
Prepared by (RESL) <i>FSKnokey</i>		Approved by (PSC) <i>[Signature]</i>		Date: <i>9/9/20</i>	Time: <i>2130</i>	

<b>DIVISION ASSIGNMENT LIST</b>		1. Branch	2. Division / Group		<b>Colfax</b>	
3. Incident Name <b>Colfax Complex</b>			4. Operational Period Date: <b>9/10/2020</b> Time: <b>0600 - 1800</b>			
<b>5. Operations Personnel</b>						
Operations Chief		<i>Rich Elliott 509.201.6280</i>		Branch Director		
Safety Officer		<i>Mark Knokey 509.869.3624</i>		Division/Group Supervisor <i>Tim Tingley 509.432.1661</i>		
<b>6. Resources Assigned this Period</b>						
RO #	Strike Team/Task Force/Resource	Leader	# People	Contact (phone, radio freq, etc.)	EMT	Remarks
					<input type="checkbox"/>	
	Local resources				<input type="checkbox"/>	
					<input type="checkbox"/>	
					<input type="checkbox"/>	
					<input type="checkbox"/>	
					<input type="checkbox"/>	
					<input type="checkbox"/>	
					<input type="checkbox"/>	
					<input type="checkbox"/>	
					<input type="checkbox"/>	
					<input type="checkbox"/>	
					<input type="checkbox"/>	
					<input type="checkbox"/>	
			0			
<b>7. Work Assignments</b>						
<ul style="list-style-type: none"> <li>• Maintain the perimeter around the fire. Conduct point protection where needed around structures.</li> </ul>						
<b>8. Special Instructions</b>						
<b>9. Communication Summary</b>						
Function	Name	Mode	Frequency			
COMMAND	Colfax Fire	A	RX: 155.4000 Tone 110.9 TX: 158.9250 Tone 97.4			
TACTICAL	VTACH 12	A	RX: 154.4525 Tone 156.7 TX: 154.4525 Tone 156.7			
AIR	DNR A/G 1	A	RX: 159.2700 Tone: 103.5 TX: 159.2700 Tone 103.5			
See Communication Plan ICS205 for Details						
Prepared by (RESL) <i>F Knowles</i>		Approved by (PSC) <i>[Signature]</i>		Date: <i>9/9/20</i>	Time: <i>2130</i>	

INCIDENT RADIO COMMUNICATIONS PLAN		Incident Name COLFAX COMPLEX		Date/ Time Prepared 9/8/20 0:22		Operational Period Date/Time 9/8/2020	
Basic Radio Channel Utilization							
Channel	Function	Frequency	Tone	Mode	Name	Assignments	
1	COMMAND	RX 155.4000	110.9	A	COLFAX FIRE	COLFAX / MANNING	
		TX 158.9250	97.4				
2	COMMAND	RX 154.0925	203.5	A	NORTH FIRE	MALDEN	
		TX 158.8725	229.1				
3	COMMAND	RX 158.8500	173.8	A	WEST FIRE		
		TX 156.0600	179.9				
4	COMMAND	RX 154.3850	151.4	A	EAST FIRE		
		TX 150.7750	127.3				
5	COMMAND	RX 159.4200	D627	A	ST COLFAX		
		TX 151.2950	D627				
6	TACTICAL	RX 155.7525	156.7	A	VCALL 10		
		TX 155.7525	156.7				
7	TACTICAL	RX 151.1375	156.7	A	VTAC 11	MALDEN NORTH	
		TX 151.1375	156.7				
8	TACTICAL	RX 154.4525	156.7	A	VTAC 12	COLFAX	
		TX 154.4525	156.7				
9	TACTICAL	RX 158.7375	156.7	A	VTAC 13	MANNING	
		TX 158.7375	156.7				
10	TACTICAL	RX 159.4725	156.7	A	VTAC 14	MALDEN SOUTH	
		TX 159.4725	156.7				
11	INTEROP	RX 153.8300		A	REDNET		
		TX 153.8300					
12	INTEROP	RX 156.1350		A	OSCCR		
		TX 156.1350	203.5				
13	AIR TO GROUND	RX 159.2700	103.5	A	DNR A/G 1	AIR TO GROUND PRIMARY	
		TX 159.2700	103.5				
14	AIR TO GROUND	RX 151.2875	103.5	A	DNR A/G 2	AIR TO GROUND SECONDARY	
		TX 151.2875	103.5				
15	EMS / SAFETY	RX 155.3400		A	HEAR	EMS INTEROP / LZ COORD	
		TX 155.3400					
16	AIRGUARD	RX 168.6250		A	AIRGUARD	EMERGENCY / SAFETY	
		TX 168.6250	110.9				

Prepared by (Communications Unit)

BRANDON MCKINNEY, COMT (509)-386-2713 *BR McP*

**Incident:** Colfax Complex | **Date:** September 10-11, 2020 | **Shift:** 0600-0600

# **SAFETY MESSAGE**

## **SAFETY IS OUR FIRST PRIORITY**

*Fire fighter safety comes first on every fire, every time*



### **Lookouts Communications Escape Routes Safety Zones**

#### **Make sure LCES is in place**

Each firefighter must know the interconnection of LCES - lookouts, communications, escape routes, and safety zones. LCES should be established before fighting the fire: Select lookouts, set up a communications plan, choose escape routes, and select safety zones.

### **MAJOR HAZARDS AND RISKS**

- |  |  |
|--|--|
| <ul style="list-style-type: none"><li>• <b>Power lines downed and damaged</b></li><li>• <b>Snags</b></li><li>• <b>Steep slopes, rolling material</b></li><li>• <b>Heavy Equipment</b></li><li>• <b>Covid-19: Exposure to self and others</b></li></ul> | <ul style="list-style-type: none"><li>• <b>Residences (destroyed, damaged, or threatened)</b></li><li>• <b>Compromised structures</b></li><li>• <b>Dehydration—drink plenty of fluids</b></li><li>• <b>Roads with high usage</b></li><li>• <b>Animals: Rattle snakes, bees, cattle</b></li></ul> |
|--|--|

#### **Here are some things to remember:**

- **Generators have been found that are back feeding the power grid. DO NOT become complacent with downed lines. Follow Powerline Safety of page 24 of you IRPG.**
- **Use extra caution when working around SNAGS.**
- **Pace yourselves when working and/or walking in steep terrain. Watch out for each other. Do not work above or below other personnel, if possible.**
- **Road conditions, a lot of traffic while traveling to the incident and some within the incident.**
- **Covid-19 Limit exposure by maintaining social distance, wear a face covering, and washing your hands. Document daily check on CTR.**

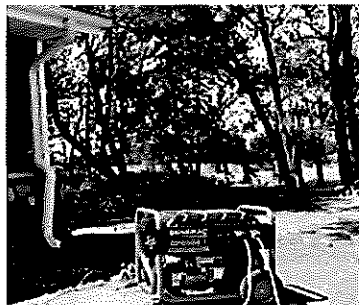

**Incident within an Incident: Review the Medical Incident Report with your crews. Make sure they are able to step into the supervisor's role if the supervisor is the injured party.**

**Safety Officer Mark Knokey**

# Fire and COVID-19 Briefing Checklist

## Self-Awareness / Screening

- Immediately separate yourself from others.
- Notify supervisor if you or others experience:
  - o Cough, more than expected
  - o Shortness of breath or difficulty breathing
  - o New loss of taste or smell
  - o Fever                      o Chills
  - o Sore throat                o Muscle pain
- Review and follow crew and division plans to isolate, triage, and transport symptomatic personnel.

## Hygiene on the Fireline

- Properly wash or sanitize your hands often, especially before and after eating or entering a public place, and after coughing or sneezing.
- Avoid handshakes and communal use items.
- Maintain a supply of hand sanitizer and hand wipes. Inform supervisor of needed resupply.
- Disinfect high touch surfaces often:
  - o Radios, phones, doors, pumps, fuel cans, etc.

## Social Distancing and Protective Equipment

- Initiate, practice, and remind others of social distancing.
- Conduct briefings and conversations outdoors and at least 6 feet apart.
- Utilize face coverings as a tool when practical.
- Clean or replace dirty face coverings, equipment, and PPE.

## Communications

- Face coverings and social distancing complicate communications. Ensure effective sender/receiver messaging.

## Protect yourself, your crew, and your camp!

Find more information: <https://www.nwccg.gov/coronavirus>.



# Finance

## IMPORTANT INFO

- Ensure that your time is recorded to the correct fire on all of your paperwork.
  - WA-WFS-114 – Manning
  - WA-WFS-116 – Babb

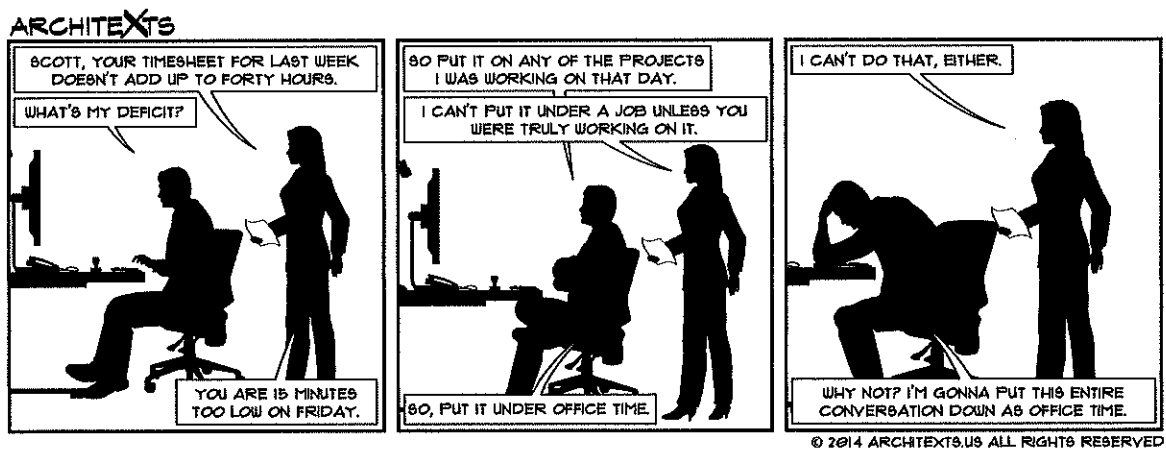

This Photo by Unknown Author is licensed under [CC BY-NC-ND](https://creativecommons.org/licenses/by-nc-nd/4.0/)



# Colfax Complex

9/10/2020

## Breaks

Breaks are an important component of our workday. They help us to stay focused, maintain positive attitudes, and ensure a safe work environment. Breaks also serve as opportunities to build or recharge crew and/or team morale.

During your break today, challenge yourself or other crewmembers to correctly answering the brain teasers below. Good luck!

---

### Brain Teasers...

1. Johnny's mother had three children. The first child was named April. The second child was named May. What was the third child's name?
2. A clerk at a butcher shop stands five feet ten inches tall and wears size 13 sneakers. What does he weigh?
3. Before Mt. Everest was discovered, what was the highest mountain in the world?
4. How much dirt is there in a hole that measures two feet by three feet by four feet?
5. What word in the English language is always spelled incorrectly?
6. Billie was born on December 28th, yet her birthday always falls in the summer. How is this possible?
7. In British Columbia you cannot take a picture of a man with a wooden leg. Why not?
8. If you were running a race and you passed the person in 2nd place, what place would you be in now?
9. Which is correct to say, "The yolk of the egg is white" or "The yolk of the egg are white?"
10. A farmer has five haystacks in one field and four haystacks in another. How many haystacks would he have if he combined them all in one field?

1. Johnny. 2. Meat. 3. Mt. Everest. It just wasn't discovered yet. 4. There is no dirt in a hole. 5. Incorrectly (except when it is spelled incorreectly). 6. Billie lives in the southern hemisphere. 7. You can't take a picture with a wooden leg. You need a camera (or iPad or cell phone) to take a picture. 8. You would be in 2nd place. You passed the person in second place, not first. 9. Neither. Egg yolks are yellow. 10. One. If he combines all his haystacks, they all become one big stack.

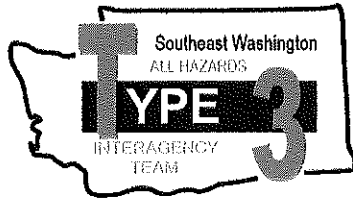

**Colfax Complex**

**IC- Bob Gear**

Sep 10, 2020

IMT Fire Information Number – 509 761 4717

<p style="text-align: center;"><b><u>PIO-t Sydney McBride</u></b></p> <p>Phone: <b>509 492-1461</b> Email: <b><u>SEWAIMTPIO@GMAIL.COM</u></b></p> <p>Facebook: <b>Southeast Washington Interagency Incident Management Team</b></p>	<p style="text-align: center;"><b><u>IMT INFORMATION LINE</u></b></p> <p style="text-align: center;"><b><u>509-761 4717</u></b></p> <p style="text-align: center;"><b><u>FACEBOOK</u></b> <b><u>@sewaimt</u></b></p>
---	--

**We are requesting pictures of fire line activity.  
Please identify people and agencies so they can get credit.**

**Before posting pictures to your own accounts:**

When you are taking pictures please make sure that the following things are in place:

If you are near the fire line, ALL PPE must be worn. Gloves, hats, etc.  
Remember your COVID Face cover if you are not on the fire line.

Please wear your COVID mask/ face cover, any time you are in camp and around other people.

Please email pictures or you can text to my number 509.761.4717

# Colfax Complex WA-WFS-114-116 IAP Map

09/10/20 Day Shift  
Penimeter as of: 09/09/2020@ 2000  
Approx: 17,716 ac

- Highway
- Primary Road
- Light-Duty Road
- Unimproved Road
- Railroad
- Pipeline
- Utility Line

0 1.5 3  
Miles





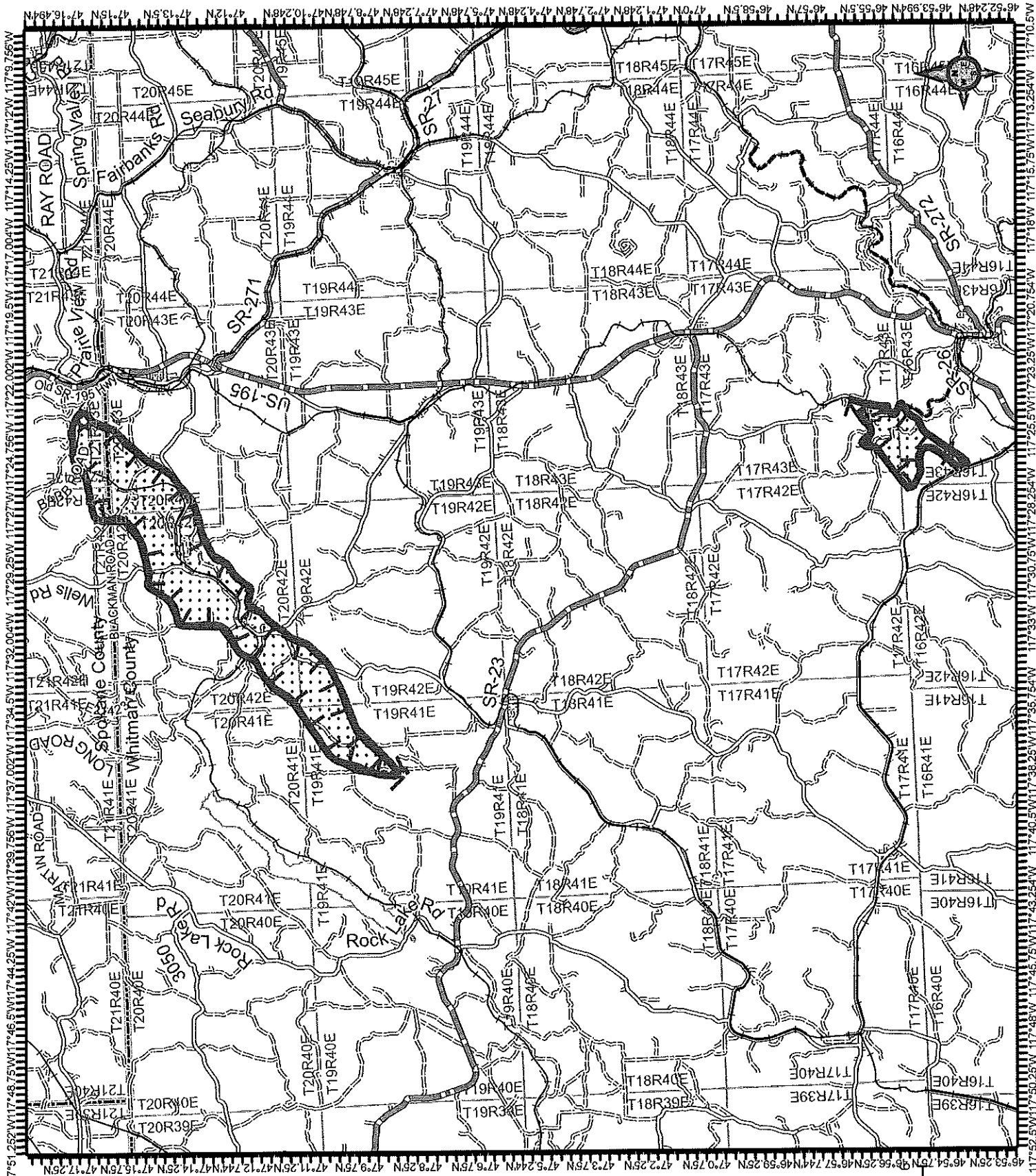

David Winter  
09.09.20  
2049 Hours

Datum: North American 1983 HARN



**Manning RD  
WA-WFS-114  
IAP Map**

09/10/20 Day Shift  
Perimeter as of: 09/09/2020@ 2000  
Approx: 2597 ac

-  Highway
-  Primary Road
-  Light-Duty Road
-  Unimproved Road
-  Railroad
-  Pipeline
-  Utility Line

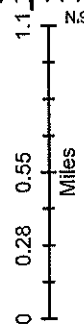
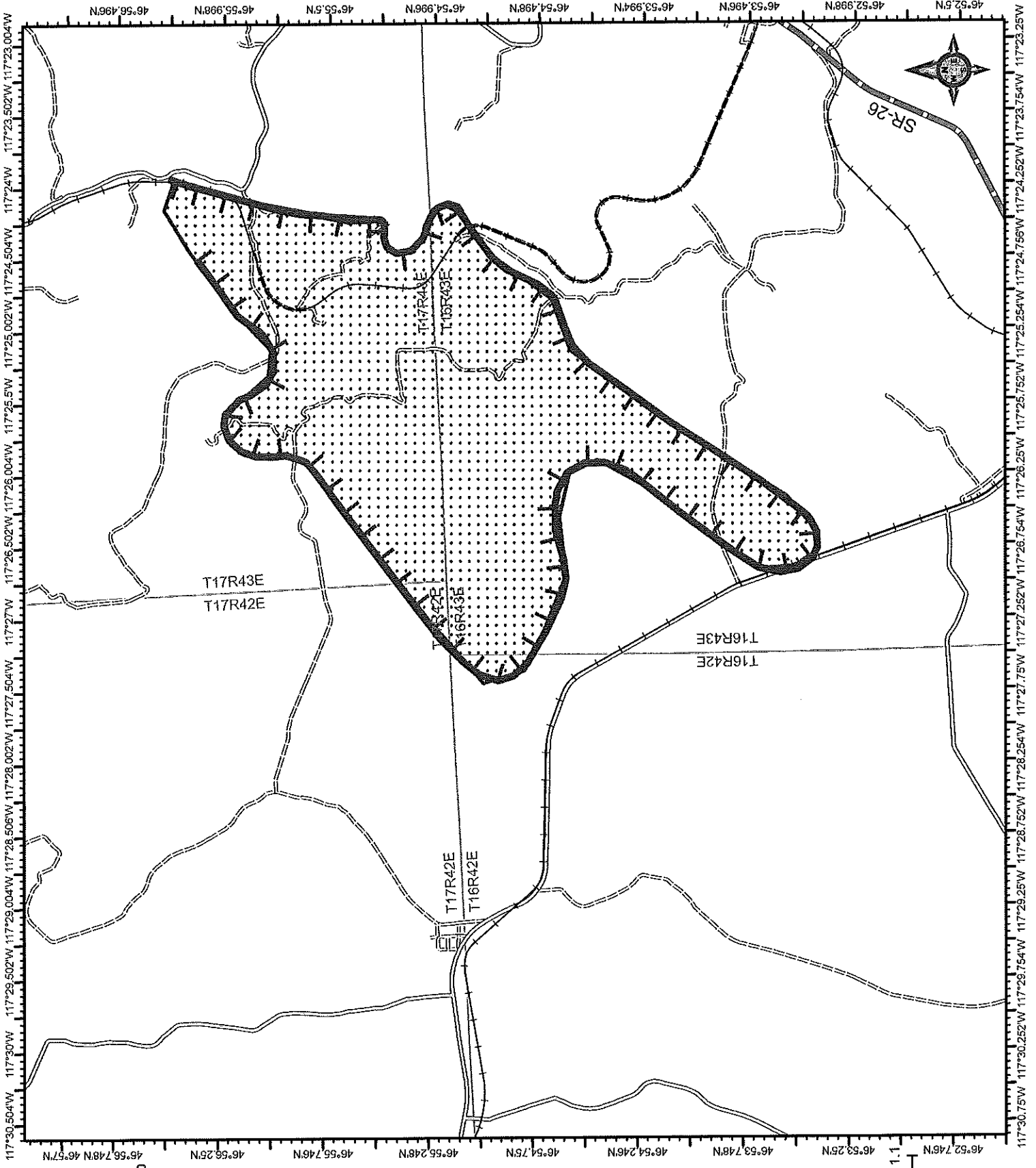







David Winter  
09.09.20  
2039 Hours

Datum: North American 1983 HARN

**Babb / Malden  
WA-WFS-116  
IAP Map**

09/10/20 Day Shift  
Perimeter as of: 09/09/2020@ 2000  
Approx: 15,120 ac

-  Highway
-  Primary Road
-  Light-Duty Road
-  Unimproved Road
-  Railroad
-  Pipeline
-  Utility Line

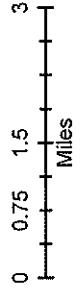
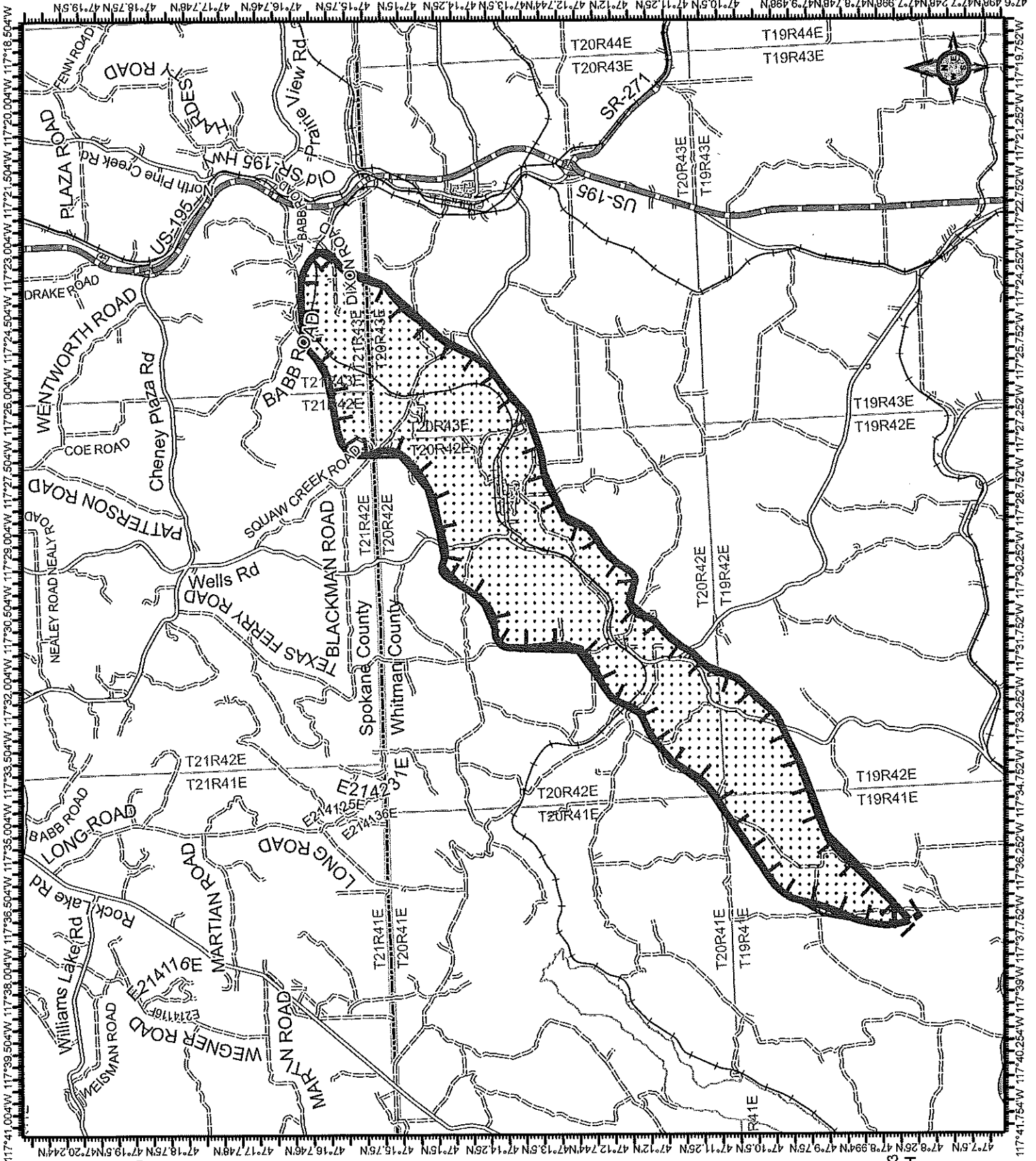

David Winter  
09.09.20  
2036 Hours

<b>Medical Plan</b> (ICS 206)	<b>1. Incident Name</b> <b>Colfax Complex</b>	<b>2. Operational Period:</b>	Date From/To: 9/10/2020 Time From/To: 0600-0600
----------------------------------	--	-------------------------------	--

<b>3. Medical Aid Stations:</b>			
Name	Location	Contact Number(s)/Frequency	Paramedics on Site? <input type="checkbox"/> Yes <input type="checkbox"/> No
			<input type="checkbox"/> Yes <input type="checkbox"/> No
			<input type="checkbox"/> Yes <input type="checkbox"/> No
			<input type="checkbox"/> Yes <input type="checkbox"/> No

<b>4. Transportation (indicate air or ground):</b>			
Name	Location	Contact Number(s)/Frequency	Level of Service <input type="checkbox"/> ALS <input checked="" type="checkbox"/> BLS
Colfax Ambulance (ground)	400 N. Mill St-Colfax	911	<input type="checkbox"/> ALS <input checked="" type="checkbox"/> BLS
Rosalia (ground)	607 S Whitman Av-Rosalia	911	<input type="checkbox"/> ALS <input checked="" type="checkbox"/> BLS
Garfield (ground)	113 N 3rd St.-Garfield	911	<input type="checkbox"/> ALS <input checked="" type="checkbox"/> BLS
LaCrosse (ground)	107 S. Main Av-Lacrosse	911	<input type="checkbox"/> ALS <input checked="" type="checkbox"/> BLS
Pullman Fire (ground)	620 S. Grand Av.-Pullman	911	<input checked="" type="checkbox"/> ALS <input type="checkbox"/> BLS
Lifeflight (air)	(800) 232.0911	911	<input checked="" type="checkbox"/> ALS <input type="checkbox"/> BLS
Spokane Co. Sheriff Rescue 3	Air transport w/hoist	911 / 509.532.8900	<b>ALS</b>

<b>5. Hospitals:</b>						
Hospital Name	Address Latitude/Longitude	Contact Number(s)/Frequency	Travel Time Air Ground	Trauma Center	Burn Center	Helipad
Whitman Community	1200 W Fairview St #9579, Colfax, WA 99111	509 397-3435		<input checked="" type="checkbox"/> Yes Level: V	<input type="checkbox"/> Yes <input type="checkbox"/> No	<input checked="" type="checkbox"/> Yes <input type="checkbox"/> No
Pullman Regional	835 SE Bishop Blvd, Pullman, WA 99163	509 332-2541		<input checked="" type="checkbox"/> Yes Level: IV	<input type="checkbox"/> Yes <input type="checkbox"/> No	<input checked="" type="checkbox"/> Yes <input type="checkbox"/> No
Gritman Medical Center	700 S Main St, Moscow, ID 83843	208 882-4511		<input type="checkbox"/> Yes Level:	<input type="checkbox"/> Yes <input type="checkbox"/> No	<input checked="" type="checkbox"/> Yes <input type="checkbox"/> No
Sacred Heart Med Center	101 W 8th Ave, Spokane, WA 99204	509.474-3131		<input checked="" type="checkbox"/> Yes Level: II	<input checked="" type="checkbox"/> Yes <input type="checkbox"/> No	<input checked="" type="checkbox"/> Yes <input type="checkbox"/> No
Deaconess Medical Center	800 W 5th Ave, Spokane, WA 99204	509 458-5500		<input checked="" type="checkbox"/> Yes Level: III	<input type="checkbox"/> Yes <input type="checkbox"/> No	<input checked="" type="checkbox"/> Yes <input type="checkbox"/> No

**6. Special Medical Emergency Procedures:**

Identify crew EMTs on the line for each Division prior to engaging. In case of urgent situation, notify your supervisor and **follow the MEDICAL INCIDENT REPORT procedure on pages 118-119 in the 2018 IRPG.** Notify operations of needs and location on command channel. Operations will notify CWICC and base camp. Minimize radio traffic and maintain situational awareness.

Check box if aviation assets are utilized for rescue. If assets are used, coordinate with Air Operations.

<b>7. Prepared by (Medical Unit Leader):</b>	Name:	Signature:
<b>8. Approved by (Safety Officer):</b>	Name:	Signature:







# MEDICAL PLAN (ICS 206 WF)

Controlled Unclassified Information//Basic

## Medical Incident Report

**FOR A NON-EMERGENCY INCIDENT, WORK THROUGH CHAIN OF COMMAND TO REPORT AND TRANSPORT INJURED PERSONNEL AS NECESSARY.**

**FOR A MEDICAL EMERGENCY: IDENTIFY ON SCENE INCIDENT COMMANDER BY NAME AND POSITION AND ANNOUNCE "MEDICAL EMERGENCY" TO INITIATE RESPONSE FROM IMT COMMUNICATIONS/DISPATCH.**

**Use the following items to communicate situation to communications/dispatch.**

**1. CONTACT COMMUNICATIONS / DISPATCH** (Verify correct frequency prior to starting report)

*Ex: "Communications, Div. Alpha. Stand-by for Emergency Traffic."*

**2. INCIDENT STATUS:** Provide incident summary (including number of patients) and command structure.

*Ex: "Communications, I have a Red priority patient, unconscious, struck by a falling tree. Requesting air ambulance to Forest Road 1 at (Lat./Long.) This will be the Trout Meadow Medical, IC is TFLD Jones. EMT Smith is providing medical care."*

Severity of Emergency / Transport Priority	<input type="checkbox"/> <b>RED / PRIORITY 1</b> Life or limb threatening injury or illness. Evacuation need is <b>IMMEDIATE</b> <i>Ex: Unconscious, difficulty breathing, bleeding severely, 2<sup>o</sup> – 3<sup>o</sup> burns more than 4 palm sizes, heat stroke, disoriented.</i> <input type="checkbox"/> <b>YELLOW / PRIORITY 2</b> Serious Injury or illness. Evacuation may be <b>DELAYED</b> if necessary. <i>Ex: Significant trauma, unable to walk, 2<sup>o</sup> – 3<sup>o</sup> burns not more than 1-3 palm sizes.</i> <input type="checkbox"/> <b>GREEN / PRIORITY 3</b> Minor Injury or Illness. <b>Non-Emergency transport</b> <i>Ex: Sprains, strains, minor heat-related illness.</i>	
Nature of Injury or Illness & Mechanism of Injury		<i>Brief Summary of Injury or Illness (Ex: Unconscious, Struck by Falling Tree)</i>
Transport Request		<i>Air Ambulance / Short Haul/Hoist Ground Ambulance / Other</i>
Patient Location		<i>Descriptive Location &amp; Lat. / Long. (WGS84)</i>
Incident Name		<i>Geographic Name + "Medical" (Ex: Trout Meadow Medical)</i>
On-Scene Incident Commander		<i>Name of on-scene IC of Incident within an Incident (Ex: TFLD Jones)</i>
Patient Care		<i>Name of Care Provider (Ex: EMT Smith)</i>

**3. INITIAL PATIENT ASSESSMENT:** Complete this section for each patient as applicable (start with the most severe patient)

Patient Assessment: See IRPG page 106

Treatment:

**4. TRANSPORT PLAN:**

Evacuation Location (if different): (Descriptive Location (drop point, intersection, etc.) or Lat. / Long.) Patient's ETA to Evacuation Location:

Helispot / Extraction Site Size and Hazards:

**5. ADDITIONAL RESOURCES / EQUIPMENT NEEDS:**

*Example: Paramedic/EMT, Crews, Immobilization Devices, AED, Oxygen, Trauma Bag, IV/Fluid(s), Splints, Rope rescue, Wheeled litter, HAZMAT, Extrication*

**6. COMMUNICATIONS: Identify State Air/Ground EMS Frequencies and Hospital Contacts as applicable**

Function	Channel Name/Number	Receive (RX)	Tone/NAC *	Transmit (TX)	Tone/NAC *
COMMAND					
AIR-TO-GRND					
TACTICAL					

**7. CONTINGENCY: Considerations:** If primary options fail, what actions can be implemented in conjunction with primary evacuation method? Be thinking ahead.

**8. ADDITIONAL INFORMATION:** Updates/Changes, etc.

**REMEMBER:** Confirm ETA's of resources ordered. Act according to your level of training. Be Alert. Keep Calm. Think Clearly. Act Decisively.