

**Planning Map**  
**Jack, Buckhead, Near Minky, & Smith Fires**  
 September 1, 2021  
 Jack Fire: 23,985 Ac  
 Rough Patch Complex: 35,054 Ac

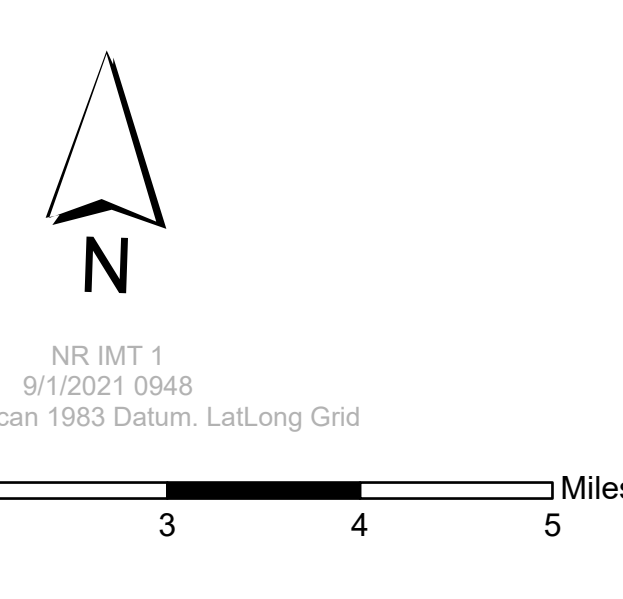

- |   |  |   |  |  |  |
|---|--|---|--|--|--|
| <ul style="list-style-type: none"> <li> Incident Command Post</li> <li> Structures</li> <li> Area To Protect</li> <li> Utility Power Lines</li> </ul> | <ul style="list-style-type: none"> <li> Fire Edge</li> <li> Contained Line</li> <li> Wildfire Daily</li> <li> Fire Perimeter</li> <li> Timber Sales</li> <li> UMPNF</li> </ul> | <ul style="list-style-type: none"> <li> Sensitive Areas</li> <li> Area To Protect</li> <li> Roadless Areas</li> <li> Wilderness</li> <li> Private Timber</li> </ul> | <ul style="list-style-type: none"> <li> BLM</li> <li> Private</li> <li> FS Wilderness</li> <li> Wilderness Boundary</li> </ul> | <ul style="list-style-type: none"> <li> Frank &amp; Jeanne Moore Steelhead SMA</li> <li> Late Succession Reserve</li> <li> Critical Habitat</li> <li> Spotted Owl</li> </ul> | <ul style="list-style-type: none"> <li> Fire History: 2000 - Present</li> <li> Planning Area</li> <li> PACE Lines</li> <li> Primary</li> </ul> |
|---|--|---|--|--|--|