

Repair Div D

Schneider Springs
WA-OWF-000453
9/13/21

102,047 acres at 9/11/21 2130



- Dip Site
- Helispot
- Division Break
- Drop Point
- Closure
- Staging Area
- Lookout
- Value at Risk
- Other
- Fire Station
- Bridge
- Structure Wrap
- Stream Crossing
- Resource Location
- Repair Point
- Landing or Log Deck
- Dozer Push
- Mobile Weather Unit
- Hazard
- Water Source
- Restricted Water Source
- Completed Dozer Line
- Completed Fuel Break
- Completed Hand Line
- Completed Road as Road
- Access or Improved Road
- Other
- Fire Edge
- Contained Line
- FS - Suitable for Passenger Car
- FS - High Clearance/Closed
- State/Private Roads
- Wildfire Daily Fire Perimeter
- Administrative FS Boundary
- Federal Wilderness Boundary
- Resource Concern
- Whitebark Pine Trees
- Seed Trees
- African Wiregrass
- Repair Needed
- No Repair Needed
- Unknown
- Repair Needed
- Unknown
- ATU Retardant Drop Line

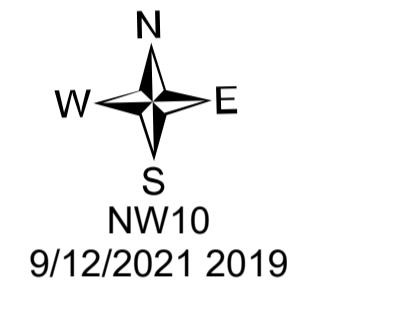

North American 1983 Datum.
Lat/Long Grid

Branch I

OKANOGAN-WENATCHEE NATIONAL FOREST

NORSE PEAK WILDERNESS

WILLIAM O. DOUGLAS WILDERNESS

DIV D

North

Bridge

Delta Staging

Warming Hut

Clover Staging

Cliffdell

H-2 (Jefferson)
Jefferson

Salmon Staging

