

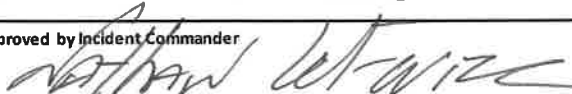

INCIDENT OBJECTIVES	1. Incident Name		2. Date Prepared	3. Time
	GRAY		08/21/2023	1900
4. Operational Period				
<b>Day Operations: 0600-2000</b>				
<b>Management Objectives:</b>				
<ul style="list-style-type: none"> <li>• Ensure Firefighter and Public Safety</li> <li>• Protection of Property and Wildland Urban Interface</li> <li>• Protection of Utilities and Critical Infrastructure</li> <li>• Protection of Natural Resource Values</li> <li>• Coordinate and communicate with the community, local cooperators, stake holders, and media regarding fire activities and status updates.</li> </ul>				
<b>Control Objectives:</b>				
<ul style="list-style-type: none"> <li>• Minimize fire growth to the greatest extent possible, providing for firefighter and public safety.</li> <li>• Restore public travel routes and infrastructure.</li> <li>• Continue structure protection efforts within and adjacent to the fireline.</li> <li>• Keep costs commensurate with values at risk by working with the local units and coordinating with the Agency Administrators and Incident Business Advisor.</li> </ul>				
6. Weather Forecast for Period				
7. General Safety Message				
8. Attachments (mark if attached)				
X	Organization List - ICS 203	X	Medical 206WF - 8 Line	Finance Message
X	Div. Assignment Lists - ICS 204	X	Safety Message	X Dutch Creek Protocol
X	Communications Plan - ICS 205		LCES – ICS 215A	X Phone List
X	Medical Plan - ICS 206	X	Weather Forecast	X Incident Map(s)
X	Air Operation Summary - ICS 220	x	Fire Behavior	x Unit Log
Prepared by Planning Section Chief			Approved by Incident Commander	
				

<b>ORGANIZATION ASSIGNMENT LIST</b>	
1. Incident Name <b>GRAY</b>	
2. Date Prepared <b>August 21, 2023</b>	3. Time Prepared <b>1800</b>
4. Operational Period <b>August 22, 2023 0600 – 2000</b>	
<b>5. Incident Commander and Staff</b>	
Position	Name
Incident Commander	Nate LeFevre
Deputy	Eric Knerr
Safety Officer	Eric Brown
Information Officer	Cheyne Rossbach / Patrick Lair
Liaison	Shawn Christianson / Greg Brody / Mark Suba (T)
Health Liaison	Rhonda Marchand (T)
HR Specialist	Vicki Cunningham
<b>6. Agency Representatives</b>	
Agency	Name
DNR	Pat Ryan (AA)
Spokane FD 3	Cody Rohrbach
WSFM	Esther Hernandez
<b>7. Planning Section</b>	
Plans Section Chief	Michael Charter
Deputy	Debbie Plummer (T)
Resource Unit	Cari Richardson (T) / Gary Duranceau (T)
Status Check-in	Katelyn Roeder / Stephanie Duwe (T) / Andrea Holmquist (T)
Situation Unit	Michael Crawford / Ray Moeckel (T)
Documentation	Chris Oelschlager
GIS Specialists	Aleksander Dozic / Zach Cravens / Jodi Thomas (Virtual)
Incident Meteorologist	Steve Bodnar
Fire Behavior Analyst	Brett Smith
<b>8. Logistics Section</b>	
Logistics Section Chief	Franklin Vaughan
Deputy	Ben Goodin (T)
Facilities	Janet Robbins / Dave LaFevre / Kelsey Lipp (T)
Base Camp Manager	Bill Bryant
Supply Unit	Michael Hanson (T)
IT Specialist	Michael Gascon / Chad Funnemark
Receiving Distribution	Spencer Johnson / Taylor Rembowski
Ordering Manager	Philip Darby (T) / Kerry Johnston (T)
Ground Support Unit	Casey Glade
Communication Unit	Seth Baumgarten
Communication Tech.	Kevin Judd / Andrew Sawyer
Food Unit	Kristy Naughton
Security Manager	Michael Fakier / Ron Tayler (T)

Medical Unit	Bill Howell / Kevin Smith (T)
<b>9. Operations Section</b>	
OPS Section - Lead	Jon Larson / Seth Merritt (T)
OPS Section - Field	Chris Orr / Scott Coulson (T)
Planning Division	Jesse Kiene (T)
Division A	Nathan Crawford
Division T	Linda Gibson / Frank Heilman (T)
Division Z	Jeff Neil
Division Night A/T/Z	Rob Gubser / Josh Fitzpatrick (T) / Nate Barron
Division	
Division	
<b>b. Air Operations Branch</b>	
AOB Director	Ted Hass
Air Attack Supervisor	Richard Lillenthal
Air Support Group Supervisor	Kevin Johnson
UAS Supervisor	Mark Hocken
Heli base Manager	Lance Jorg
<b>10. Finance Section</b>	
Finance Section Chief	Andrea Andresen / Lori Bailey (T)
Deputy	Nina Hardin
Time Unit	Beverly Hollars / Heather Wall
Procurement	Audrey Mainwaring
Comp/Claims	Patty Westgate (Virtual)
Cost Unit	Dede Domingos
Prepared by Cari Richardson	



# Fire Weather Forecast



**FORECAST NO:** 2  
**FORECAST FOR:** Tuesday & Tuesday Night  
**SHIFT DATE:** 08/22/2023  
**DATE AND TIME ISSUED:** 08/21/2023 at 2000

**NAME OF FIRE:** Gray  
**UNIT:** WA-DNR  
**SIGNED:** Steve Bodnar - Incident Meteorologist  
 405-203-9850 (cell) / [stephen.bodnar@noaa.gov](mailto:stephen.bodnar@noaa.gov)

**WEATHER DISCUSSION:** A frontal boundary draped across Eastern WA will be the focus for showers and a few thunderstorms on Tuesday. With that comes a 60-70% chance for wetting rains and 15% chance for lightning. Winds will largely come from the south and southeast through the day but will likely waver at times to the southwest with passing showers. Showers will wane by Tuesday evening with drier conditions Tuesday night.

## **TUESDAY:**

**WEATHER:** Mostly cloudy with scattered showers. Slight chance for thunderstorms. Heavier showers will be capable of brief heavy downpours.

**RAINFALL AMOUNTS:** 0.07 – 0.23”

**MAXIMUM TEMPERATURE:** 71-75°

**MINIMUM RELATIVE HUMIDITY:** 55-59%.

### **20-FOOT WINDS:**

- Southeast to south 7 to 10 mph with gusts around 15 mph.
- Winds occasionally shifting to the southwest with brief gusts to 25 mph with passing showers.

**CHANCE OF WETTING RAIN ( $\geq 0.10$ ”):** 65%

**LIGHTNING ACTIVITY LEVEL:** 2

**HAINES INDEX:** 2

**MIXING HEIGHTS/INVERSIONS:** Weak surface inversions (1000 ft AGL) in the morning mixing out near 2200 ft AGL around 1400 hrs.

**AVIATION:** Showers with ceilings largely 4000-6000 feet AGL; heavier showers could produce brief MVFR conditions.

## **TUESDAY NIGHT:**

**WEATHER:** Mostly cloudy with a 15% chance of showers before 2000 becoming partly cloudy and dry.

**RAINFALL AMOUNTS:** T - 0.01”

**MINIMUM TEMPERATURE:** 48-52°

**MAXIMUM RELATIVE HUMIDITY:** 82-85%.

### **20-FOOT WINDS:**

- South 6 to 10 mph becoming south to southwest 8 to 13 mph gusts near 18 mph after 0500 hrs.

**CHANCE OF WETTING RAIN ( $\geq 0.10$ ”):** 0%

**LIGHTNING ACTIVITY LEVEL:** 1

**MIXING HEIGHTS/INVERSIONS:** Weak inversions around 1000 ft AGL.

**EXTENDED OUTLOOK:** A cold front sweeps through early Wednesday morning ushering breezy southwest winds through Wednesday afternoon. Much drier air will arrive with the post-frontal air mass drying humidity levels back near 20-25% despite temperatures only warming into the 70s. A warming trend arrives Thursday and continues into the weekend with temperatures rebounding back to 90 degrees. A disturbance lifting into the area on Friday will bring the next threat for showers and thunderstorm activity with light precipitation amounts.

## FIRE BEHAVIOR FORECAST

<b>FORECAST NUMBER:</b> 2	<b>TYPE OF FIRE:</b> Wildland
<b>FIRE NAME:</b> Gray	<b>OPERATIONAL PERIOD:</b> August 22, 2023 – Monday
<b>DATE ISSUED:</b> August 21, 2023	<b>TIME ISSUED:</b> 2000
<b>UNITS:</b> Washington DNR	<b>SIGNED:</b> /s/ <i>Brett Smith - FBAN</i>

**WEATHER SUMMARY:** See Fire Weather Forecast in IAP  
 \*\*\*Higher relative humidity again today – possible showers\*\*\*

### FUELS:

**GENERAL:** Primary fuel types are timber with grass understory and scattered riparian areas with aspen stands. Agriculture fields include standing wheat, wheat stubble, and irrigated grass/hay. Timber litter is fluffy. Grasses are mostly to fully cured. Fine fuels are reacting to increased atmospheric moisture with FDFM rising to above critical levels. Heavy fuels remain seasonably dry with 1000-hr fuels estimated at 9% fuel moisture.

Local fire danger index ERC has lowered over the previous 48 hours and continues to trend lower.

### TOPOGRAPHY:

**GENERAL:** The area in and around the fire is generally flat with ~200 feet elevation changes across the landscape. Small rocky ridges, low-lying riparian areas, and small lakes are scattered throughout the fire.

### General/Potential Fire Behavior:

**TODAY:** Limited fire behavior throughout the shift today.

Forecast relative humidity and precipitation should lead to minimal fire perimeter growth potential with moderate fire activity interior. Heavy fuels will continue to consume with light to moderate smoke production. Fire activity (open flame and smoke production) may temporarily increase in response to forecast wind gusts. Spotting potential is greatly reduced today and any fire spread would likely be through conduction only.

\*\*\*Assumes no precipitation received\*\*\*

<u>Max Spotting Distance</u> 500 feet or less <u>Probability of Ignition</u> 20 - 40%	<u>Fuel Type/Model</u>	<u>Maximum Rate of Spread</u>	<u>Maximum Flame Length</u>
 Low surface spread rates possible, but unlikely	Timber with Grass (FM 2)	<i>Head 10-15 feet/min</i> Flank 3-5 ft/min	<i>Head 2-4 ft</i> Flank 1-2 ft
	Timber with light understory (TU2)	<i>Head 5-10 feet/min</i> Flank 1-2 ft/min	<i>Head 2-4 ft</i> Flank 1-2 ft
	Timber Litter (TL8)	<i>Head 3-5 feet/min</i> Flank 1-2 ft/min	<i>Head 2-4 ft</i> Flank 1-2 ft

### SPECIFIC:

**ALL DIVISIONS:** Limited perimeter spread potential again today. Scattered pockets of interior heat, continued creeping, and smoldering are likely. Ash pits may form as heavy materials consume completely. Fire impacted trees continue to fall creating watch out situations and possible flare ups.

**NIGHT SHIFT:** Limited fire activity will continue until 2000 then minimal activity overnight.

**INITIAL ATTACK:** Assuming no measurable precipitation is received and under general forecast weather conditions utilize “head fire” information in the table above for estimates of anticipated fire behavior.

### AIR OPERATIONS:

Low clouds and shower activity may limit aviation use through mid-day. Minimal smoke impacts.

### SAFETY:

*Ash Pits* – Watch for areas of fluffy white ash as deep holes may be hidden underneath. Watch for white ash to turn black with precipitation, any areas that turn white again may indicate residual heat in that area.

DIVISION ASSIGNMENT LIST		1. Branch	2. Division / Group <b>A</b>		Page 1 of 2		
3. Incident Name <b>Gray</b>		4. Operational Period Date: August 22, 2023      Time: 0600-2000					
5. Operations Personnel							
Operations Lead	Jon Larson / Seth Merritt (T)		Division / Group Supervisor	Nathan Crawford			
Operations Field	Chris Orr / Scott Coulson (T)		Safety Officer	Eric Brown			
Planning Division	Jesse Kiene (T)		Air Attack Supervisor	Ted Hass			
6. Resources Assigned this Period							
	Strike Team / Task Force / Resource Designator	Leader	Number Persons	Trans. Needed	Notes	Tentative Last Work Day	
1.	O-7 TFLD	Todd Olson	1			09/01	
2.							
3.	C-3 CR2I Chelan	Bryan Lyle	18			09/01	
4.	C-6 CR2I NW-COA #1	Urisha Marconi	20			09/03	
5.							
6.	O-91 FMOD David Rains	Mike Lind	2			09/02	
7.							
8.	E-15 ENG4 Chewack Wildfire Inc	Nick Miller	3			09/01	
9.	E-11 ENG6 Late Summer	Bradley Baker	3			09/01	
10.	E-112 ENG6 Alder Creek Fire, INC	Nick Vanderhoof	3			09/03	
11.	E-113 ENG6 Alder Creek Fire, INC	Aaron Shiuely	3			09/03	
12.	E-114 ENG6 Alder Creek Fire, INC	Autumn Leeman	3			09/03	
13.	E-115 ENG6 Alder Creek Fire, INC	Steve Ward	3			09/03	
14.							
15.	O-2109 STEN	Mark Harper	1		SPS Strike Team	09/01	
16.	E-2110 ENG6 BR133	Adam Merritt	3		SPS Strike Team	09/01	
17.	E-2111 ENG6 BR144	Jeff Salatino	3		SPS Strike Team	09/01	
18.	E-2112 ENG6 BR161	Luke Lindgren	3		SPS Strike Team	09/01	
19.	E-2113 ENG6 BR101	Russ Ordonia	3		SPS Strike Team	09/01	
20.	E-2115 WTS2 TN183	Rudy Case	2		SPS Strike Team	09/01	
21.							
7. Control Operations Mop up and secure perimeter in the area around Eastern State Hospital, Lakeland Village and the Medical Lake Community.							
8. Special Instructions Avoid downed powerlines, smoke exposure from infrastructure, and other Wildland Urban Interface hazards. E-89 AMB2 Best Practice Medicine LLC, EMPF Wasden and EMTF Mullen – shared between Division A / Z							
9. Division / Group Communication Summary							
Function	Frequency	System	Channel	Function	Frequency	System	Channel
Command Repeater	See Comm Plan			Command	See Comm. Plan		
TAC				Air To Ground	See Comm. Plan		
Prepared by (Resource Unit Leader): Cari Richardson			Approved by (Planning Section Chief): Michael Charter		Date: 08/21/2023	Time: 1900	

DIVISION ASSIGNMENT LIST		1. Branch		2. Division / Group			
<b>Gray</b>		Date: August 22, 2023		Time: 0600-2000			
5. Operations Personnel							
Operations Lead		Jon Larson / Seth Merritt (T)		Division / Group Supervisor		Nathan Crawford	
Operations Field		Chris Orr / Scott Coulson (T)		Safety Officer		Eric Brown	
Planning Division		Jesse Kiene (T)		Air Attack Supervisor		Ted Hass	
6. Resources Assigned this Period							
Strike Team / Task Force / Resource Designator		Leader		Number Persons	Trans. Needed	Notes	Tentative Last Work Day
22.	O-2327 STEN	Erik Hotchkiss		1		Mason County Strike Team	09/01
23.	E-2137 ENG5 BR18-2	Ron Satterfield		3		Mason County Strike Team	09/01
24.	E-2134 ENG6 BR56	Michael Healy		3		Mason County Strike Team	09/01
25.	E-2135 ENG6 BR61	Keaton Christian		3		Mason County Strike Team	09/01
26.	E-2136 ENG6 BR 16-1	Jonathon Vogel		3		Mason County Strike Team	09/01
27.	E-2139 WTS2 T82	Kyle Severance		1		Mason County Strike Team	09/01
28.							
29.	E-123 WTS2 SKWANT Tender Company	Yancy Epperson		1			09/03
30.							
31.	E-49 DZR3 Todd Anderson Excavating	Joe Coppersmith		2			09/02
32.							
33.	O-2326 SOFR	Brenda Rodgers		1			09/02
34.							
35.							
36.							
37.							
38.							
39.							
40.							
41.							
42.							
7. Control Operations							
Mop up and secure perimeter in the area around Eastern State Hospital, Lakeland Village and the Medical Lake Community.							
8. Special Instructions							
Avoid downed powerlines, smoke exposure from infrastructure, and other Wildland Urban Interface hazards. E-89 AMB2 Best Practice Medicine LLC, EMPF Wasden and EMTF Mullen – shared between Division A / Z							
9. Division / Group Communication Summary							
Function	Frequency	System	Channel	Function	Frequency	System	Channel
Command Repeater	See Comm Plan			Command	See Comm. Plan		
TAC				Air To Ground	See Comm. Plan		
Prepared by (Resource Unit Leader): Cari Richardson			Approved by (Planning Section Chief): Michael Charter			Date: 08/21/2023	Time: 1900

DIVISION ASSIGNMENT LIST		1. Branch	2. Division / Group <b>T</b>		Page 1 of 2		
3. Incident Name <b>Gray</b>		4. Operational Period Date: August 22, 2023      Time: 0600-2000					
5. Operations Personnel							
Operations Lead	Jon Larson / Seth Merritt (T)		Division / Group Supervisor	Linda Gibson / Frank Heilman (T)			
Operations Field	Chris Orr / Scott Coulson (T)		Safety Officer	Eric Brown			
Planning Division	Jesse Kiene (T)		Air Attack Supervisor	Ted Hass			
6. Resources Assigned this Period							
	Strike Team / Task Force / Resource Designator	Leader	Number Persons	Trans. Needed	Notes	Tentative Last Work Day	
1.	O-4 TFLD	Tom Shedd	1			09/02	
2.							
3.	C-1 CR2I Klickitat 441	Brandon Humpherys	19			09/01	
4.	C-9 CRW2 Tri-Cities Forestry, LLC	Alfredo Torres	20			09/02	
5.	C-11 CRW2 Alpine Services	Jose Silva	20			09/02	
6.	CR2I CR 6201 BLM	Shawn Rambo	10		LOAN		
7.							
8.	O-42 FMOD Bailey Logging	Cole Harris	2			09/01	
9.							
10.	ENG3 4618	Josh Peterson	2		LOAN		
11.	E-9 ENG4 Methow River Wild Fire	Rich Harvey	3			09/01	
12.	E-10 ENG5 Rainier Wildfire E511	Everton Bedward	3			09/01	
13.	E-12 ENG5 Rainier Wildfire E508	Spencer Shaw	3			09/01	
14.	E-13 ENG5 Rainier Wildfire E06	Mike Sutton	3			09/01	
15.	E-62 ENG5 Liberty Wildfire Inc	Kevin Klinkert	3			09/01	
16.	E-63 ENG5 Osprey Wildfire LLC	Sierra Dahlen	3			09/02	
17.	E-65 ENG5 Osprey Wildfire LLC	Nathan Smallbec	3			09/02	
18.	E-68 ENG5 Glacier Peak Wildfire Inc	Erin Finnegan	3			09/02	
19.	E-64 ENG6 Burkhart	Aaron Burkhart	3			09/02	
20.	E-111 ENG6 Backcountry	Ambrose Bessette	3			09/02	
21.							
7. Control Operations Mop up and secure along the communities around Salnave Rd, Granit Lake Rd, and Baker Rd to I-90							
8. Special Instructions Avoid downed powerlines, smoke exposure from infrastructure and other Wildland Urban Interface hazards.							
9. Division / Group Communication Summary							
Function	Frequency	System	Channel	Function	Frequency	System	Channel
Command Repeater	See Comm Plan			Command	See Comm. Plan		
TAC				Air To Ground	See Comm. Plan		
Prepared by (Resource Unit Leader): Gary Duranceau			Approved by (Planning Section Chief) Michael Charter			Date 08/21/2023	Time 1900



DIVISION ASSIGNMENT LIST		1. Branch	2. Division / Group		T		Page 2 of 2		
3. Incident Name <b>Gray</b>		4. Operational Period Date: August 22, 2023				Time: 0600-2000			
5. Operations Personnel									
Operations Lead		Jon Larson / Seth Merritt (T)		Division / Group Supervisor		Linda Gibson / Frank Heilman (T)			
Operations Field		Chris Orr / Scott Coulson (T)		Safety Officer		Eric Brown			
Planning Division		Jesse Kiene (T)		Air Attack Supervisor		Ted Hass			
6. Resources Assigned this Period									
	Strike Team / Task Force / Resource Designator	Leader	Number Persons	Trans. Needed	Notes	Tentative Last Work Day			
22.	O-2101 STEN	Gordon Brooks	1		SW Strike Team	09/01			
23.	O-2108 TFLD (T)	Joe Stiffler	1		SW Strike Team	09/01			
24.	E-2103 ENG3 B43	Cassie Knierim	4		SW Strike Team	09/01			
25.	E-2105 ENG5 SQ102	Galen Sarkinen	3		SW Strike Team	09/01			
26.	E-2102 ENG6 SQ36	Brian George	2		SW Strike Team	09/01			
27.	E-2104 ENG6 B51	Jacob Warricks	3		SW Strike Team	09/01			
28.	E-2107 WTS2 WT103	Danny Vandermark	1		SW Strike Team	09/01			
29.									
30.	E-2356 WTS2 SCFD10	Jerry McCoury	2			09/01			
31.	E-40 WTS2 L&W Unlimited LLC	Jim Sleck	1			09/01			
32.	E-44 WTS2 Dow Excavation	Will Skipworth	2			09/01			
33.									
34.	O-32 HEQB	Philip Sehafto	1			09/02			
35.	O-38 HEQB	David Sund	1			09/02			
36.	O-44 HEQB(T)	Martin Cozart	1			09/02			
37.									
38.	E-80 DZR3	Steve Hofbauer	2			09/02			
39.	E-81 DZR3 Douglas Logging, Inc	Steve Douglas	1			09/02			
40.	E-85 DZR3 Christman Trucking Inc	Laura Christman	2			09/02			
41.	E-48 DZR4 Cummings Trucking	Kyle Cummings	2			09/01			
42.									
43.	O-47 SOFR	Chris Wyrobek	1			09/02			
44.	E-117 AMB2 AMR	Robinson/Salapka	2			09/04			
7. Control Operations Mop-up and secure along the communities around Salnave Rd, Granite Lake Rd, and Baker Rd to I-90.									
8. Special Instructions Avoid downed powerlines, smoke exposure from infrastructure and other Wildland Urban Interface hazards.									
9. Division / Group Communication Summary									
Function	Frequency	System	Channel	Function	Frequency	System	Channel		
Command Repeater	See Comm Plan			Command	See Comm. Plan				
TAC				Air To Ground	See Comm. Plan				
Prepared by (Resource Unit Leader): Gary Duranceau			Approved by (Planning Section Chief) Michael Charter			Date 08/21/2023	Time 1900		

DIVISION ASSIGNMENT LIST		1. Branch	2. Division / Group		Z	Page 1 of 2	
3. Incident Name <b>Gray</b>		4. Operational Period Date: August 22, 2023      Time: 0600-2000					
5. Operations Personnel							
Operations Lead	Jon Larson / Seth Merritt (T)		Division / Group Supervisor	Jeff Neil			
Operations Field	Chris Orr / Scott Coulson (T)		Safety Officer	Eric Brown			
Planning Division	Jesse Kiene (T)		Air Attack Supervisor	Ted Hass			
6. Resources Assigned this Period							
	Strike Team / Task Force / Resource Designator	Leader	Number Persons	Trans. Needed	Notes	Tentative Last Work Day	
1.	O-100 TFLD	Shaun Turner	1			09/03	
2.	O-99 TFLD (T)	Austin Hatten	1			09/03	
3.							
4.	C-2 CR2I Steelhead Enterprises LLC	J Kuhnhausen	20			09/01	
5.							
6.	O-43 FMOD Bailey Logging	Austin Ross	2			09/01	
7.	O-92 FMOD David Raines	Kendall Cain	2			09/02	
8.							
9.	E-8 ENG5 E8207 WA-SPS	Adin Simmons	4			09/01	
10.	E-14 ENG4 Chewack Wildfire Inc ID69	Tim Reinbolt	3			09/01	
11.	E-60 ENG5 Methow River Wildfire	Rondeau Cameron	3			09/02	
12.	E-61 ENG5 Liberty Wildfire, INC	E Kenney	3			09/02	
13.	E-105 ENG5 Wild Fire Services, INC	Tim Logozzo Jr	3			09/03	
14.	E-73 ENG6 WA-OWF-E-691	James Stillwaugh	2			09/02	
15.	E-76 ENG6 Late Summer Wildfire LLC	Jacob McCroskey	4			09/02	
16.	E-78 ENG6 Liberty Wildfire, INC	Clif Middleton	3			09/02	
17.	E-94 ENG6 Work Horse, INC	Tye Straight	3			09/02	
18.	E-100 ENG6 Arrowhead Forestry, LLC	Anthony Jenner	3			09/02	
19.	E-108 ENG6 LL Meadows Wildfire, INC	Neil Reynaud	3			09/03	
20.							
7. Control Operations Mop up and secure perimeter around Clear Lake and Blue Heron Road. Identify and mitigate hazard trees along I-90.							
8. Special Instructions Avoid downed powerlines, smoke exposure from infrastructure and other Wildland Urban Interface hazards. E-89 AMB2 Best Practice Medicine LLC, EMPF Wasden and EMTF Mullen – shared between Division A / Z							
9. Division / Group Communication Summary							
Function	Frequency	System	Channel	Function	Frequency	System	Channel
Command Repeater	See Comm Plan			Command	See Comm. Plan		
TAC				Air To Ground	See Comm. Plan		
Prepared by (Resource Unit Leader): Gary Duranceau			Approved by (Planning Section Chief) Michael Charter		Date 08/21/2023	Time 1900	

DIVISION ASSIGNMENT LIST		1. Branch	2. Division / Group				
3. Incident Name <b>Gray</b>		4. Operational Period Date: August 22, 2023      Time: 0600-2000				<b>Z</b>	<b>Page 2 of 2</b>
5. Operations Personnel							
Operations Lead	Jon Larson / Seth Merritt (T)		Division / Group Supervisor	Jeff Neil			
Operations Field	Chris Orr / Scott Coulson (T)		Safety Officer	Eric Brown			
Planning Division	Jesse Kiene (T)		Air Attack Supervisor	Ted Hass			
6. Resources Assigned this Period							
	Strike Team / Task Force / Resource Designator	Leader	Number Persons	Trans. Needed	Notes	Tentative Last Work Day	
21.	O-2125 STEN	Alex Hickey	1		NW2 Strike Team	09/01	
22.	O-2132 STEN (T)	Jasen Allen	1		NW2 Strike Team	09/01	
23.	E-2129 ENG3 BR60	Peter Drott	3		NW2 Strike Team	09/01	
24.	E-2126 ENG3 BR68B	Samantha Devoir	3		NW2 Strike Team	09/01	
25.	E-2127 ENG6 BR49	Curtis Welch	3		NW2 Strike Team	09/01	
26.	E-2128 ENG6 BR324	Brandt Walde	3		NW2 Strike Team	09/01	
27.	E-2131 WTS2 T312	Jeo Nannecq	1		NW2 Strike Team	09/01	
28.							
29.	E-41 WTS2 Todd Anderson Excavation Inc	Josh Apthorp	1			09/01	
30.							
31.	E-38 DZR4 Dirtworxs Land Management	Matt Aleria	1			09/01	
32.	E-84 DZR4 Kelsi N Beaman	Neil Morrison	2			09/02	
33.							
34.	O-13.82 SOFR	Leo Engleson	1			09/01	
35.							
36.							
37.							
38.							
39.							
40.							
41.							
7. Control Operations Mop up and secure perimeter around Clear Lake and Blue Heron Road. Identify and mitigate hazard trees along I-90.							
8. Special Instructions Avoid downed powerlines, smoke exposure from infrastructure and other Wildland Urban Interface hazards. E-89 AMB2 Best Practice Medicine LLC, EMPF Wasden and EMTF Mullen – shared between Division A / Z							
9. Division / Group Communication Summary							
Function	Frequency	System	Channel	Function	Frequency	System	Channel
Command Repeater	See Comm Plan			Command	See Comm. Plan		
TAC				Air To Ground	See Comm. Plan		
Prepared by (Resource Unit Leader): Gary Duranceau			Approved by (Planning Section Chief) Michael Charter		Date 08/21/2023	Time 1900	

<b>DIVISION ASSIGNMENT LIST</b>		1. Branch	2. Division / Group <b>NIGHT A</b>				<b>Page 1</b>
3. Incident Name <b>Gray</b>		4. Operational Period Date: August 22, 2023      Time: 1830 - 0600					
5. Operations Personnel							
Operations Lead	Jon Larson / Seth Merritt (T)		Division / Group Supervisor	Rob Gubser			
Operations Field	Chris Orr / Scott Coulson (T)		Safety Officer	Eric Brown			
Planning Division	Jesse Kiene (T)		Air Attack Supervisor	Ted Hass			
6. Resources Assigned this Period							
	Strike Team / Task Force / Resource Designator	Leader	Number Persons	Trans. Needed	Notes	Tentative Last Work Day	
1.	O-5 TFLD	John Preston	1			09/01	
2.	E-2353 ENG3 Attack 30	Alex Turner	3			09/01	
3.	E-71 ENG5 WA-SES 4505	Matthew Anderson	4			09/02	
4.	E-72 ENG5 SES 4104	Jason Walker	4			08/30	
5.	E-77 ENG6 LL Meadows Wildfire INC	Wes James	3			09/02	
6.							
7.	O-15 TFLD	Trenton Crossland	1			09/03	
8.	E-6 ENG5 DNR-PCS 2204	Nathan Jurgensen	4			09/01	
9.	E-7 ENG5 DNR-PCS-2403	Madison Huber	4			09/01	
10.	E-8 ENG5 DNR-SPS-8207	Adin Simmons	4			09/01	
11.	E-66 ENG5 Wild Fire Services, INC	Melvin Thompson	3			09/02	
12.	E-70 ENG5 DNR-SES-4303	Gavin Brumley	4			09/02	
13.							
14.	E-2356 WTS2 Spokane 10	Jerry McCoury	2			09/01	
15.							
16.							
17.							
18.							
19.							
20.							
21.							
22.							
7. Control Operations Monitor fire behavior. Secure, hold, and mop up containment line and around structures where safe to access.							
8. Special Instructions Avoid downed powerlines, smoke exposure from infrastructure, and other Wildland Urban Interface hazards. E-117 AMB1 AMR located at DP80							
9. Division / Group Communication Summary							
Function	Frequency	System	Channel	Function	Frequency	System	Channel
Command Repeater	See Comm Plan			Command	See Comm. Plan		
TAC				Air To Ground	See Comm. Plan		
Prepared by (Resource Unit Leader): Cari Richardson			Approved by (Planning Section Chief): Michael Charter		Date: 08/21/2023	Time: 1900	

<b>DIVISION ASSIGNMENT LIST</b>		1. Branch	2. Division / Group <b>NIGHT T</b>				<b>Page 1</b>
3. Incident Name <b>Gray</b>		4. Operational Period Date: August 22, 2023      Time: 1830 - 0600					
5. Operations Personnel							
Operations Lead	Jon Larson / Seth Merritt (T)		Division / Group Supervisor	Josh Fitzpatrick (T)			
Operations Field	Chris Orr / Scott Coulson (T)		Safety Officer	Eric Brown			
Planning Division	Jesse Kiene (T)		Air Attack Supervisor	Ted Hass			
6. Resources Assigned this Period							
	Strike Team / Task Force / Resource Designator	Leader	Number Persons	Trans. Needed	Notes	Tentative Last Work Day	
1.	O-78 TFLD	Donald Smith	1			09/01	
2.							
3.	O-2332 STEN	Travis Hots	1		SPS 6 Strike Team		
4.	E-2142 ENG6 Valley Regional	Jordan Gustafson	3		SPS 6 Strike Team	09/01	
5.	E-2143 ENG5 South Kitsap Fire & Rescue	Aaron Kapporbers	2		SPS 6 Strike Team	09/01	
6.	E-2144 ENG6 Pierce County 13	Dylan Tapia	2		SPS 6 Strike Team	09/01	
7.	E-2145 ENG5 East Pierce Fire and Rescue	Adam Lathrop	2		SPS 6 Strike Team	09/01	
8.	E-2147 WTS2 Puget Sound RFA	Justin Averre	2		SPS 6 Strike Team	09/01	
9.							
10.	E-49 DZR3 Todd Anderson Excavation Inc	Justin Hatten	2			09/01	
11.							
12.	E-107 ENG6 JR Wildfire LLC	James Rettstatt	3			09/02	
13.	E-69 ENG6 Steven Wilson	Josh Adkins	3			09/02	
14.	E-74 ENG6 Steven Wilson	Clinton Adkins	2			09/02	
15.	E-75 ENG6 Northridge Wildfire LLC	Erik Sackett	3			09/02	
16.							
17.							
18.							
19.							
20.							
21.							
22.							
23.							
7. Control Operations Monitor fire behavior. Secure, hold, and mop up containment line and around structures where safe to access.							
8. Special Instructions Avoid downed powerlines, smoke exposure from infrastructure, and other Wildland Urban Interface hazards. E-117 AMB1 AMR located at DP80							
9. Division / Group Communication Summary							
Function	Frequency	System	Channel	Function	Frequency	System	Channel
Command Repeater	See Comm Plan			Command	See Comm. Plan		
TAC				Air To Ground	See Comm. Plan		
Prepared by (Resource Unit Leader): Cari Richardson			Approved by (Planning Section Chief): Michael Charter		Date: 08/21/2023	Time: 1900	

<b>DIVISION ASSIGNMENT LIST</b>		1. Branch	2. Division / Group <b>NIGHT Z</b>				<b>Page 1</b>
3. Incident Name <b>Gray</b>		4. Operational Period Date: August 22, 2023      Time: 1830 - 0600					
5. Operations Personnel							
Operations Lead	Jon Larson / Seth Merritt (T)		Division / Group Supervisor	Nate Barrons			
Operations Field	Chris Orr / Scott Coulson (T)		Safety Officer	Eric Brown			
Planning Division	Jesse Kiene (T)		Air Attack Supervisor	Ted Hass			
6. Resources Assigned this Period							
	Strike Team / Task Force / Resource Designator	Leader	Number Persons	Trans. Needed	Notes	Tentative Last Work Day	
1.	O-2117 STEN	Schuyler Murphy	1			08/31	
2.	E-53 ENG6 Aegis Logistics, LLC 304739	Shailee Evans	3		NW Strike Team 1	09/01	
3.	E-54 ENG6 Aegis Logistics, LLC A80075	Kerri Hendrix	3		NW Strike Team 1	09/01	
4.	E-55 ENG6 Aegis Logistics, LLC 199085	Roy Varney	3		NW Strike Team 1	09/01	
5.	E-57 ENG6 Aegis Logistics, LLC 161373	Randy Wiggins	3		NW Strike Team 1	09/01	
6.	E-56 ENG6 Aegis Logistics, LLC 790650	Jerry Perry	3		NW Strike Team 1	09/01	
7.	E-79 ENG6 Northridge Wildfire, LLC	Tiffa Nordhagen	3		NW Strike Team 1	09/01	
8.							
9.	E-41 WTS2 Todd Anderson Excavation	Justin Hatten	1			09/01	
10.							
11.							
12.							
13.							
14.							
15.							
16.							
17.							
18.							
19.							
20.							
21.							
22.							
23.							
7. Control Operations Monitor fire behavior. Secure, hold, and mop up containment line and around structures where safe to access.							
8. Special Instructions Avoid downed powerlines, smoke exposure from infrastructure, and other Wildland Urban Interface hazards. E-117 AMB1 AMR located at DP 80							
9. Division / Group Communication Summary							
Function	Frequency	System	Channel	Function	Frequency	System	Channel
Command Repeater	See Comm Plan			Command	See Comm. Plan		
TAC				Air To Ground	See Comm. Plan		
Prepared by (Resource Unit Leader): Cari Richardson			Approved by (Planning Section Chief) Michael Charter		Date 08/21/2023	Time 1900	

<b>DIVISION ASSIGNMENT LIST</b>		1. Branch	2. Division / Group <b>NIGHT STRUCTURE RESPONSE GROUP</b>				Page 1
3. Incident Name <b>Gray</b>		4. Operational Period Date: August 22, 2023      Time: 1830 - 0600					
5. Operations Personnel							
Operations Lead	Jon Larson / Seth Merritt (T)		Division / Group Supervisor	Joe Kupferling			
Operations Field	Chris Orr / Scott Coulson (T)		Safety Officer	Eric Brown			
Planning Division	Jesse Kiene (T)		Air Attack Supervisor	Ted Hass			
6. Resources Assigned this Period							
	Strike Team / Task Force / Resource Designator	Leader	Number Persons	Trans. Needed	Notes	Tentative Last Work Day	
1.	O-2149 TFLD	Joe Kupferling	1				
2.							
3.	E-2150 ENG1 Shoreline Fire E163	Jacob Yake	4			09/03	
4.	E-2151 ENG1 Bremerton Fire Dept. E2	Carlo Celeste	4			09/03	
5.	E-2152 ENG1 Buckley Fire Dept. E35	Jeff Brook	3			09/03	
6.	E-2153 WTS2 Bainbridge Island T21	Josh Foley	2			09/03	
7.	E-2154 WTS2 Central Pierce T67	Denny Anderson	2			09/03	
8.							
9.							
10.							
11.							
12.							
13.							
14.							
15.							
16.							
17.							
18.							
19.							
20.							
21.							
22.							
23.							
7. Control Operations Monitor fire behavior, respond to all 911 structural related responses as requested through incident communications.							
8. Special Instructions Avoid downed powerlines, smoke exposure from infrastructure, and other Wildland Urban Interface hazards. E-117 AMB2 Ambach EMPF DP 80.							
9. Division / Group Communication Summary							
Function	Frequency	System	Channel	Function	Frequency	System	Channel
Command Repeater	See Comm Plan			Command	See Comm. Plan		
TAC				Air To Ground	See Comm. Plan		
Prepared by (Resource Unit Leader): Cari Richardson			Approved by (Planning Section Chief): Michael Charter		Date: 08/21/2023	Time: 1900	

DIVISION ASSIGNMENT LIST				1. Branch <b>LAW</b>		2. Division / Group <b>Spokane County Sheriff</b>			
3. Incident Name <b>Gray</b>				4. Operational Period Date: August 22, 2023      Time: 0600 – 0600					
5. Operations Personnel									
Commander AM		Undersheriff Richey							
Commander PM		Lt. Elliott		Command Post		509-438-0595			
City of Spokane									
6. Resources Assigned this Period									
Strike Team / Task Force / Resource Designator		Leader		Number Persons	Trans. Needed	Notes		Tentative Last Work Day	
1.	Gray/Francher						Traffic Control Point		
2.									
3.	Pine/902						Area Checkpoint		
4.									
5.	902/Green Gate LN						Area Checkpoint		
6.									
7.	Hallett/Evergreen						Area Checkpoint		
8.									
9.	Grace/Freeman						Area Checkpoint		
10.									
11.	4 Lakes/Silver Lake						Area Checkpoint		
12.									
13.	Murphy/Silver Lake						Area Checkpoint		
14.									
15.	Granite/Murphy						Area Checkpoint		
16.									
17.	I90 / Salnave – No Eastbound traffic on Salnave						Area Checkpoint		
18.									
19.	I-90/Salnave Ramps						Area Checkpoint		
20.									
21.	S Granite Lake/Salnave						Area Checkpoint		
22.									
7. Control Operations									
8. Special Instructions Area patrols provided by additional law enforcement units									
9. Division / Group Communication Summary									
Function	Frequency	System	Channel	Function	Frequency	System	Channel		
Command Repeater	See Comm Plan			Command	See Comm. Plan				
TAC				Air To Ground	See Comm. Plan				
Prepared by (Resource Unit Leader): Cari Richardson			Approved by (Planning Section Chief): Michael Charter			Date: 08/21/2023		Time: 1900	



**AIR OPERATIONS SUMMARY 220**

Prepared By: Ted Hass AOB

Prepared Date: 08/21/2023

Prepared Time: 1900

<b>INCIDENT NAME:</b> GRAY FIRE	<b>OPS PERIOD DATE:</b> 08/22/2023	<b>START TIME:</b> 0900	<b>END TIME:</b> 2100	<b>SUNRISE:</b> 0553	<b>SUNSET:</b> 1951
<b>Risk Assessment Mitigations, Special Instructions, and Remarks:</b> Assess Risk Daily: assess visibility, weather, complacency, communications, fatigue, etc. – Make informed risk acceptance decisions.  Be aware of public aircraft landing at airport. CTAF:122.9		<b>Helibase Info:</b> Davenport airport (68S) 47°39.12 N 118°10.43 W Elev. 2424 ft		<b>TER Info:</b> NO TFR NOTAM D issued	
<b>Helicopter Lend/Lease.</b>					

Position	NAME	PHONE #	FREQUENCIES	type	Freq. TX	Freq. RX	FIXED-WING Avail/ Type/ Make-Model/ N#/ AIRTANKERS- order through Dispatch
AOBD	Ted Hass	541-646-1318	Air/Air Primary TFR	AM	128.0750	128.0750	
ATGS/HLCO	Jamie Lilenthal	541-529-9492	Air/Air Secondary	AM	118.3500	118.3500	Air Attack – 404LH
ASGS	Kevin Johnson	541-660-5880					E-Mail ALL Costs to:
ASGS/UASS*	Mark Hocken	541-261-1085	A/G Primary	FM	163.5750	163.5750	
HEBM	Lance Jorg	971-291-7443	A/G Secondary	FM	169.8125	169.8125	Email CTRs to: 2023.gray.finance@firenet.com
			DECK	FM	163.1000	163.1000	
NEWICC		509-685-6912					
UAS	Eddy Hensley	360-688-4570	Air Guard	FM	168.625 (110.9)	168.6250	*UASS – Unmanned Aerial System Supervisor A-21334750

**HELICOPTERS:**

FAA N#	T Y	MAKE/ MODEL	BASE	AVAIL	REMARKS	FAA N#	T Y	MAKE/ MODEL	BASE	AVAIL	REMARKS
404LH	3	Bell 407	Davenport	0930	Air Attack/Recon/Bucket						

INCIDENT RADIO COMMUNICATIONS PLAN I-205			1. INCIDENT NAME	2. DATE/TIME PREPARED	3. OPERATIONAL PERIOD DATE/TIME						
			<b>Gray Fire</b>	08/21/2023 1700hrs	08/22/2023 All Shifts						
4. BASIC RADIO CHANNEL UTILIZATION											
Ch #	Function	Channel Name	Assignment	RX Freq	N/W	RX Tone/NAC	TX Freq	N/W	TX Tone/NAC	Mode Analog (A) Digital (D) Mixed (M)	Remarks
1	Command	CMD1		168.4750	N	100.0	165.4000	N	100.0	A	Located on Booth Hill
2	Command	CMD2		173.0375	N	100.0	167.3250	N	100.0	A	Located on Needham Hill
3	Tactical	TAC3	DIV A	168.0500	N	100.0	168.0500	N	100.0	A	
4	Tactical	TAC4	DIV T	168.6000	N	100.0	168.6000	N	100.0	A	
5	Tactical	TAC5	DIV Z	166.7250	N	100.0	166.7250	N	100.0	A	
6	Tactical	TAC6	NIGHT DIV	166.7750	N	100.0	166.7750	N	100.0	A	
7	Tactical	TAC7	SRG*	168.2500	N	100.0	168.2500	N	100.0	A	
8	Tactical	TAC8		168.2000	N	100.0	168.2000	N	100.0	A	
9	Local Rptr	SMRA 3		153.9350	N	110.9	159.0300	N	179.9	A	Local Fire Command RPTR
10	Local Rptr	DNR CHNY		159.3675	N	156.7	151.4675	N	156.7	A	
11	Tactical	REDNET		153.8300	N		153.8300	N	156.7	A	State Interop Tac
12	Local A/G	DNR A/G 2		151.2875	N	103.5	151.2875	N	103.5	A	
13	A/G	A/G Pri		163.5750	N		163.5750	N		A	
14	A/G	A/G Sec		169.8125	N		169.8125	N		A	
15	Medical A/G	VMED29		155.3475	N		155.3475	N	156.7	A	A/G use w/ Air Ambulance
16	AIRGUARD			168.6250	N		168.6250	N	110.9	A	
5. Special Instructions: *Structure Response Group.....Communications 24Hr Phone: 208-891-7948											
6. I-205 Prepared By: Communications Unit Leader				Name: Seth Baumgarten	Signature: <i>Seth Baumgarten</i>						

## GRAY FIRE SAFETY MESSAGE

8/22/23

### SAFETY CULTURE (not the glove police)



**WILDLAND  
FIREFIGHTER  
FOUNDATION**



The culture of wildland firefighting is steeped in history and tradition, some good, some bad. Unfortunately, we have had to develop many of our policies after the death of firefighters. The National Fallen Firefighters Foundation has developed the “EVERYONE GOES HOME” program. There is a list of 16 Life Safety Initiatives. There is a lot of information! In today’s safety message we will focus on just a few safety culture behaviors.

- **DRIVING:** Everyone in the cab needs to be looking out for hazards. Drivers: pay attention follow the rules of the road! If you aren’t the driver, study the route, be a co-pilot not a backseat driver!
- **LEADERS:** Give relevant operational briefings before engaging the work. Read the IRPG Operational Leadership Principles. Go ahead, do it now, I can wait..
- **CREW MEMBERS:** Seek a mentor. Develop a strong work ethic by working hard, smiling, and caring more about your buddies wellbeing than your own.
- **PROFESSIONALISM:** Your words and actions reflect your character. You represent every firefighter out here. Be proud of that and be nice.
- **LEARN AND TRAIN:** Be a student of not just fire but the human interactions within the fire environment. Pay attention!
- **SEEK OUT THE OLD SALTY FIREFIGHTERS FOR SOME HISTORICAL PERSPECTIVE:** You don’t know where you’re going, until you know where you came from.
- **GIVE ATTENTION TO YOUR PERSONAL LIFE:** As you head home remember to re-enter life a bit slower with patience and care. De-stress using healthy techniques.

**QR code link to video about the South Canyon Fire.**

**Be well and have a good shift.**

*NW-7 Safety Officer Eric Brown*

# Human Resources Message



## Coping With Stress

- **Take breaks from watching, reading, or listening to news stories,** including those on social media. It's good to be informed but hearing about the traumatic event constantly can be upsetting. Consider limiting news to just a couple of times a day and disconnecting from phone, tv, and computer screens for a while.
- **Take care of yourself.** Eat healthy, exercise, get plenty of sleep, and give yourself a break if you feel stressed out.
- **Take care of your body.**
  - Take deep breaths, stretch, or meditate.
  - Try to eat healthy, well-balanced meals.
  - Exercise regularly.
  - Get plenty of sleep.
  - Avoid excessive alcohol, tobacco, and substance use.
  - Continue with routine preventive measures.
- **Make time to unwind.** Try to do some other activities you enjoy.
- **Talk to others.** Talk with people you trust about your concerns and how you are feeling. Share your problems and how you are feeling and coping with a parent, friend, counselor, doctor, or pastor.
- **Connect with your community- or faith-based organizations.**
- **Avoid drugs and alcohol.** These may seem to help, but they can create additional problems and increase the stress you are already feeling.
- **Recognize when you need more help.** If problems continue or you are thinking about suicide, talk to a psychologist, social worker, or professional counselor.

# Public Information

For fire inquiries please call (509) 903-5563

-or-

Email: [2023.gray@firenet.gov](mailto:2023.gray@firenet.gov)

## LOST & FOUND

We have lost and found! Please stop by the Info shop in ICP to find your lost goods!

# Thank you!

## Logistics Message

Dining	0530 – 0930 1730 – 2130
Showers	0500 – 1100 1400 – 2200
Lunch & Ice	Available At Reefer (New Location by Supply)
Quiet Hours	2100 – 0500
Communications	Available Next to Briefing
Ground Support	0600 – 2200
Supply	0600 – 2200
Medical	In camp medical available at school entrance.

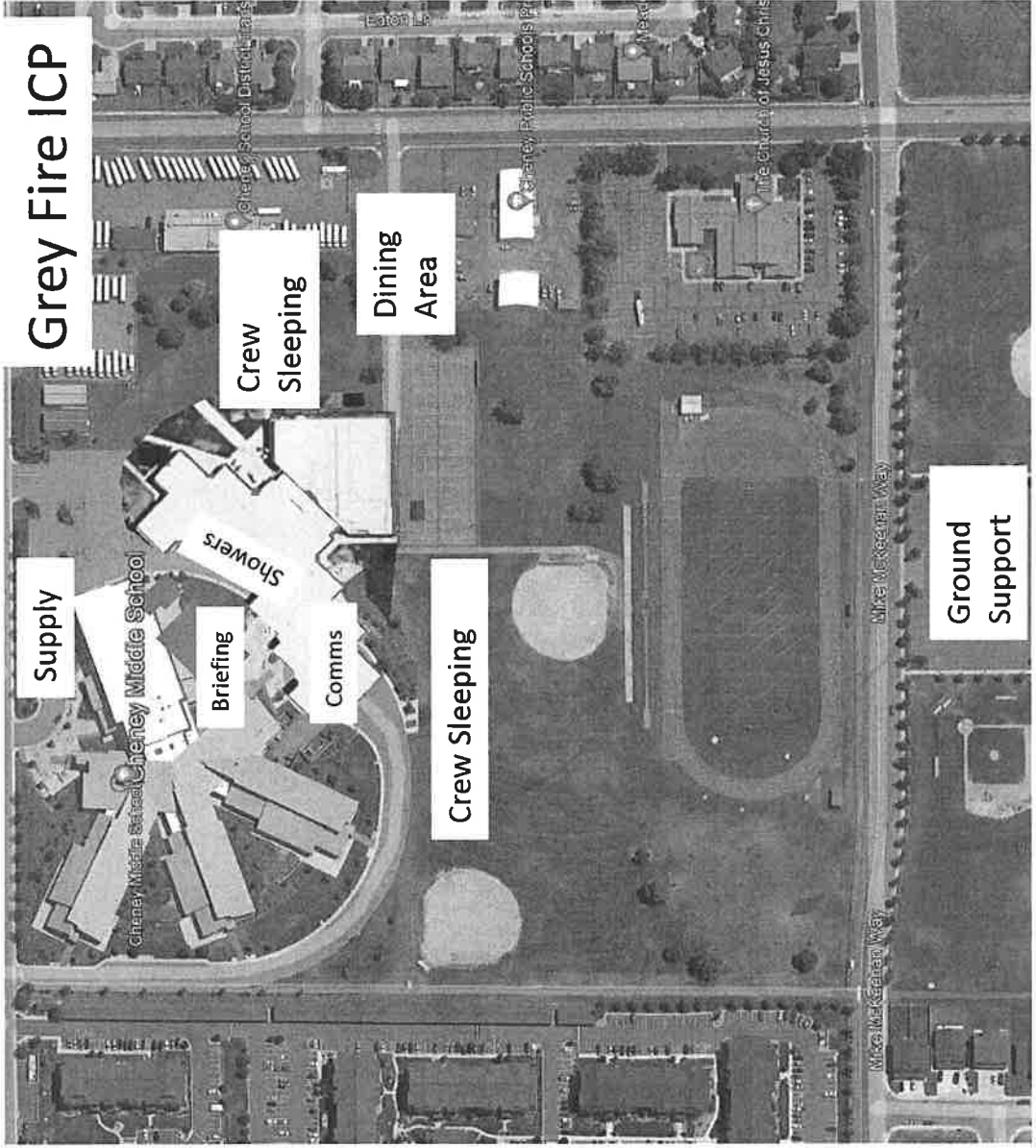

# Grey Fire ICP

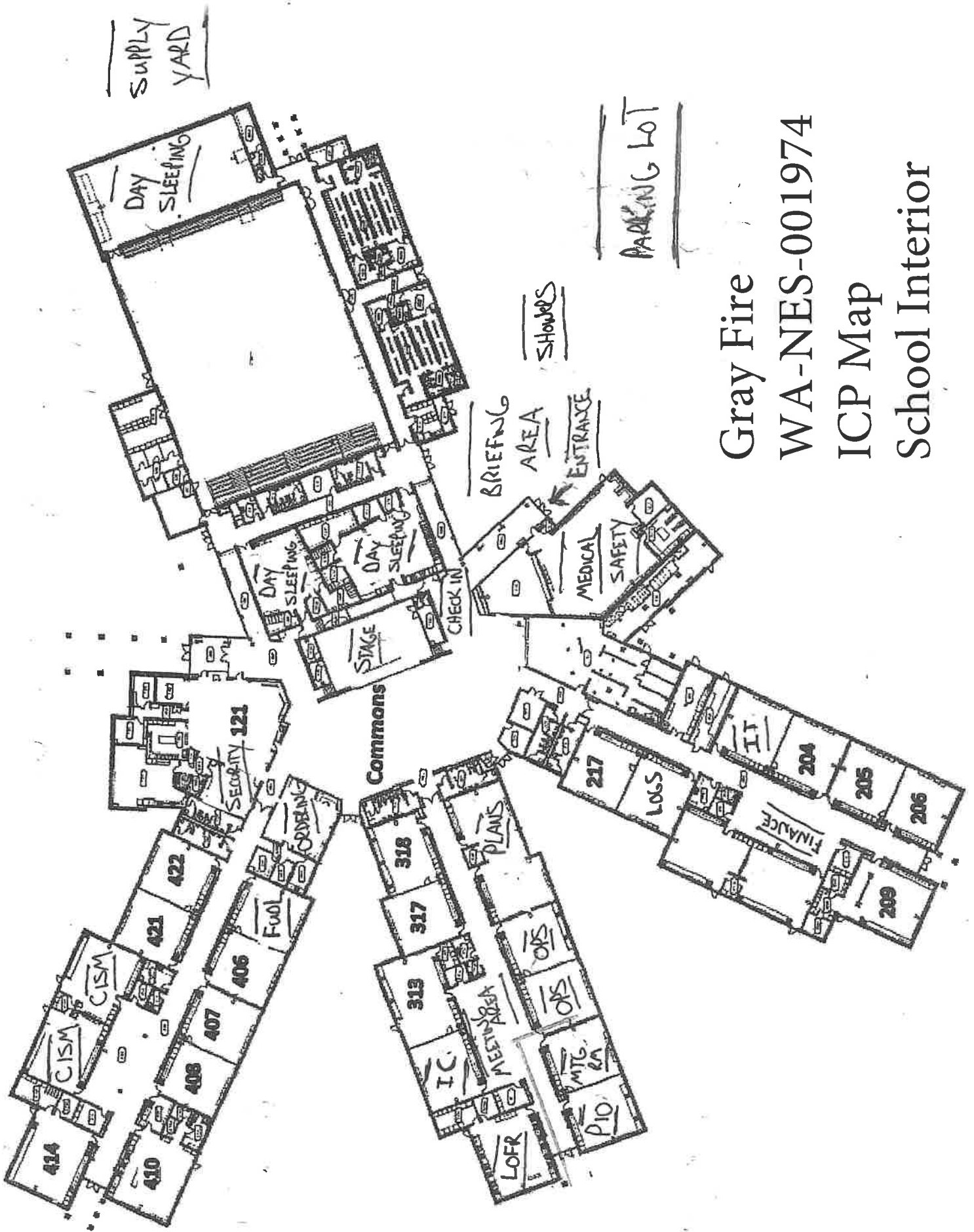

Gray Fire  
 WA-NES-001974  
 ICP Map  
 School Interior





Team 7 Line Supply Order		Order #			
Date & Time Order Placed	Deliver To Location/Time (Division, Drop Point, Heli Spot, Lat/Long)	Delivery Method (Driver, Heli, DIVS to P/U)			
Order received in Communications (name & time)					
Ordered by (name and Position)					
Ground Contact					
Contact Freq.					
Order received in Helibase by (name & time)					
Special Instructions/line length/ elevation					
Order shipped to line by (name & time)					
#	Item	Amount	#	Item	Amount
1	Meals #1842 MRE 12/Cs		33	Bath in a Bag, Large # 0712	
2	Water 0048 5 gal cubies		34	Bath in a Bag, Small # 0206	
3	Gatorade 24/Cs		35	Coffee Kit #0480	
4	Batteries, AA #0030 24/pg		36	Coffee 3lb Can	
5	Batteries, AAA #7471 24/pg		37	Folda-Tank 1500 gal # 0664	
6	Gas Unleaded/5 gal		38	Pumpkin 3000 gal. # 0568	
7	2 Cycle Oil #7724 5 Gal mix		39	Backpack Pump # 0909	
8	2 Cycle Oil #3444 1 Gal. mix		40	Mark III pump + Kit # 0148	
9	Diesel (5 gal.)		41	Lightweight Pump + Kit # 8606	
10	Bar Oil #1880 Gal.		42	Volume Pump + # 1222	
11	Bar Oil # 1869, Qt		43	Hose 1 1/2" # 1239 100' lg	
12	Shovel # 0171		44	Hose 1" # 1238 100' lg	
13	Pulaski # 0146		45	Hose 3/4" # 1016 50' lg	
14	McLeod # 0296		46	Reducer 1 1/2" to 1" # 0010	
15	Combi #1180		47	Reducer 1" to 3/4" # 0733	
16	Chainsaw Kit # 0340		48	Gated "Y" 1 1/2" # 0231	
17	Drip Torch # 0241 Empty		49	Gated "Y" 1" # 0259	
18	Fusee #0105		50	Gated "Y" 3/4" # 0904	
19	Sleeping Pad # 1566		51	In-line Tee 1 1/2" to 1" # 0230	
20	Sleeping Bag # 0022		52	Nozzle KK 1 1/2" # 1082	
21	Fly Tent #0070		53	Nozzle KK 1" # 1081	
22	Plastic Sheeting # 0143		54	Nozzle 3/4" # 0136	
23	Parachute Cord # 0533		55	Nozzle, Forester 1" # 0024	
24	Fiber Tape # 0222		56	Sprinkler kit #1048	
25	Garbage Bags # 0021		57		
26	Leadline 3000 lbs. # 0528		58		
27	Cargo Net 3000lb # 0531		59	Team 7 Hose Lay Kit	
28	Swivel 3000lb # 0526		60		
29	Slingable Bag 72 gal. Blivet # 0426		61		
30	Foam 5 gal. # 1145		62		
31	Toilet Paper # 0142		63		
32			64		

**TEAM 7 HOSE LAY KIT**  
7/16/2014

Item	Amount
1 1/2 in. synthetic hose	1000 ft.
1 in. synthetic hose	500 ft.
3/4 in. garden hose	500 ft.
1 1/2 in. gated wye	5 ea.
1 1/2 in. - 1 in. reducers	5 ea.
1 in. combination nozzle	5 ea.
1 in. - 3/4 in. reducer	5 ea.
3/4 in. valve, shutoff, ball	5 ea.
3/4 in. Nozzle	5 ea.
3/4 in gated wyes	5 ea.

**SPRINKLER KIT NFES # 1048**

Item	Amount
Sprinkler head w/couplings	4 ea.
3/4 in. garden hose	250 ft.
1 1/2 x 1 1/2 x 1 in. Tee	4 ea.
1 x 3/4 reducer	4 ea.
1 1/2 in. - 1 in. reducers	1 ea.
3/4 in gated wyes	2 ea.
3/4 in. valve, shutoff, ball	4 ea.
3/4 in. Nozzle	1 ea.
3/4 pressure regulator,	4 ea.
1 in. nozzle, plastic 60 GPM	1 ea.
10 in. adjustable wrench	1 ea.

**LINE ORDER PROCESS**

Line orders from the field should go through the Communication Unit via radio (primary) or 24-hour phone number shown cover of the IAP. All other supply requests should be submitted, in-person, to the Supply Unit.



## *Need Air Travel to get Home?*

**CONTACT DMOB AT LEAST 48-HOURS BEFORE  
DEMOB DAY**

**Jay Lord, DMOB**

**Phone: 603-396-0923**

**email: Jay\_lord@firenet.gov**

## **Information needed:**

Name EXACTLY as it appears on your identification

Gender

Date of birth

Departure & destination airports

City for rental car return

Email and phone number



# Gray Fire C & G Contact List

Incident Commander	LeFevre	Nathan	<a href="mailto:nlefevre@blm.gov">nlefevre@blm.gov</a>	541-255-6595
Deputy Incident Commander	Knerr	Eric	<a href="mailto:hardinknerr@gmail.com">hardinknerr@gmail.com</a>	541-219-6579
Safety Officer	Broyles	Matt	<a href="mailto:admbroyles@gmail.com">admbroyles@gmail.com</a>	541-591-6151
Safety Officer	Brown	Eric	<a href="mailto:ericbrown0523@gmail.com">ericbrown0523@gmail.com</a>	928-699-3477
Liaison Officer	Christianson	Shawn	<a href="mailto:shawn.christianson.adm@colvilletribes.com">shawn.christianson.adm@colvilletribes.com</a>	509-429-3348
Liaison Officer	Brody	Greg	<a href="mailto:greg_brody@firenet.gov">greg_brody@firenet.gov</a>	503-482-8071
Liaison Officer (T)	Suba	Mark	<a href="mailto:mark_suba@firenet.gov">mark_suba@firenet.gov</a>	541-219-9048
Public Information Officer	Rossbach	Cheyne	<a href="mailto:rossbac@blm.gov">rossbac@blm.gov</a>	541-579-0648
Public Information Officer	Lair	Patrick	<a href="mailto:patrick.lair@usda.gov">patrick.lair@usda.gov</a>	208-772-3283
Finance Section Chief	Andresen	Andrea	<a href="mailto:andrea_andresen@nps.gov">andrea_andresen@nps.gov</a>	530-375-7205
Finance Section Chief (T)	Bailey	Lori	<a href="mailto:lori.bailey@usda.gov">lori.bailey@usda.gov</a>	541-589-0806
Operations Section Chief (Lead)	Larson	Jon	<a href="mailto:jon_larson@fws.gov">jon_larson@fws.gov</a>	208-631-6488
Operation Section Chief (Lead - T)	Merritt	Seth	<a href="mailto:smerritt@esf-r.org">smerritt@esf-r.org</a>	425-501-7384
Operations Section Chief (Planning)	Coulson	Scott	<a href="mailto:scoulson@snofire26.org">scoulson@snofire26.org</a>	425-770-1910
Operations Section Chief (Field)	Orr	Christopher	<a href="mailto:christopher_orr@nps.gov">christopher_orr@nps.gov</a>	530-640-1464
Operations Section Chief (Field - T)	Kiene	Jesse	<a href="mailto:jkienes@blm.gov">jkienes@blm.gov</a>	541-531-5568
Air Operations Branch Director	Hass	Ted	<a href="mailto:halfhass2@gmail.com">halfhass2@gmail.com</a>	541-646-1318
Air Operations Branch Director	Johnson	Kevin	<a href="mailto:kevin.l.johnson@usda.gov">kevin.l.johnson@usda.gov</a>	541-660-5880
Logistics Section Chief	Vaughan	Franklin	<a href="mailto:vaughan711@gmail.com">vaughan711@gmail.com</a>	859-619-7244
Logistics Section Chief (T)	Goodin	Benjamin	<a href="mailto:benjamin.goodin@usda.gov">benjamin.goodin@usda.gov</a>	541-589-2941
Planning Section Chief	Charter	Michael	<a href="mailto:mmcharter270@gmail.com">mmcharter270@gmail.com</a>	509-879-4910
Planning Section Chief (Deputy)	Crawford	Michael	<a href="mailto:mcrawfor@blm.gov">mcrawfor@blm.gov</a>	458-212-0501
Planning Section Chief (T)	Plummer	Debra	<a href="mailto:dplummer@blm.gov">dplummer@blm.gov</a>	509-991-0334

# ACTIVITY LOG (ICS 214)

<b>1. Incident Name:</b>	<b>2. Operational Period:</b> Date From: _____ Date To: _____ Time From: _____ Time To: _____	
<b>3. Name:</b>	<b>4. ICS Position:</b>	<b>5. Home Agency (and Unit):</b>
<b>6. Resources Assigned:</b>		
Name	ICS Position	Home Agency (and Unit)
<b>7. Activity Log:</b>		
Date/Time	Notable Activities	
8. Prepared by: Name: _____	Position/Title: _____	Signature: _____
ICS 214, Page 1	Date/Time: _____	





**ANDY PALMER-DUTCH CREEK PROTOCOL**

**UPDATED 08/22/2023**

LEADER’S INTENT: To establish **approximate** travel times from key areas of the fire to ICP/MEDICAL UNIT. See Medical Plan ( “206”) for travel times via air.

<b>Ground Transport Only</b>	<b>ICP MED UNIT</b>	<b>Sacred Heart Spokane (Level 2)</b>		<b>Harborview Seattle (Level 1 Burn Center) (Approximate)</b>
Granite Lake Road via Betz	6 minutes	36 minutes		4.5 hours
Granite Lake Road via Salnave	10 minutes	40 minutes		4.5 hours
Granite Lake Road via 904	6 minutes	36 minutes		4.5 hours
Lakeland Village	20 minutes	50 minutes		4.5 hours
Medical Lake Station 311	15 minutes	45 minutes		4.5 hours
I-90 and 904 intersection	5 minutes	35 minutes		4.5 hours
I-90 and Salnave Road	15 minutes	45 minutes		4.5 hours

**STUDY YOUR MAP, KNOW WHERE YOU ARE WORKING, AND KNOW WHERE YOUR MEDICAL HELP IS.**

**SITUATIONAL AWARENESS IS YOUR JOB.**

# Medical Plan

1. Incident / Project Name			2. Operational Period				
Gray Fire			Date/Time: 8/22/23 Day and Night				
3. Ambulance Services							
Name	Phone and Emergency Frequency		Advanced Life Support (ALS)		YES	NO	
AMR Ambulance Spokane County	911				X		
4. Air Ambulance Services							
Name	Type of Aircraft & Capability						
Lifeflight Network 911	Helo Nurse and Paramedic						
Airlift Northwest 911	Helo with 2 nurse's						
5. Hospitals							
Name Complete Address	Degrees Decimal Minutes	Travel Time From ICP Air Ground		Phone	Helipad Yes No		Level of Care
Providence Sacred Heart 101 W 8th Spokane Wa	Lat: N 47 38.95 Long: W 117 24.78	10	25	509-474-3131	X		Level 2
Providence Holy Family 5633 N. Lidgerwood Spokane	Lat: N 47 42.57 Long: W 117 24.48	10	35	509-482-0111	X		Level 3
Deaconess Hospital 800 W 5th Ave Spokane Wa	Lat: N 47 39.1 Long: W 117 25.46	10	25	509-458-5800	X		Level 3
Harborview Medical Center 325 9th ave Seattle Wa	Lat: N 47 36.2 Long: W 122 19.4	N/A	N/A	206-744-4074	X		Level1 and Burn Center
Branch							
<b>ICP 740 W Betz Rd Cheney Wa</b>	EMS Responders & Capabilities:	Bill Howell MEDL EMT / Kevin Smith MEDLt EMPF AMBO 1--DAYS					
	Equipment Available on Scene:	AMR ALS AMBO ALS Gear, BLS Gear, ALS Transport					
	Medical Emergency Channel:	Command A/G VMED29					
	ETA for Ambulance to Scene:						
	Air:						
	Ground:						
	Approved Heli-Spot						
Lat:							
Long:							
<b>DIV A</b>	EMS Responders & Capabilities:	AMBO 2 ALS DIV A and Z					
	Equipment Available on Scene:	ALS Gear and Transport					
	Medical Emergency Channel:	Command A/G VMED29					
	ETA for Ambulance to Scene:						
	Air:	10 to 20 minutes					
	Ground:	10 to 20 minutes					
	Ambulance Rendezvous Points	Sta 33 12611 W Melville AMR Post 904 N 47 34.32 W 117 40.98 Sta 311 S Lefevre St Medical Lake City Hall N 47 34.32 W 117 40.98 I-90 and Salnave RD N 47 30.3 W117 41.3					
<b>DIV T</b>	EMS Responders & Capabilities:	Ambo 1 ALS At ICP					
	Equipment Available on Scene:	ALS Gear and Transport					
	Medical Emergency Channel:	Command A/G VMED29					
	ETA for Ambulance to Scene:						
	Air:	10 to 20 minutes					
	Ground:	10 to 20 minutes					
	Ambulance Rendezvous Points	Sta 33 12611 W Melville AMR Post 904 N 47 34.32 W 117 40.98 Sta 311 S Lefevre St Medical Lake City Hall N 47 34.32 W 117 40.98 I-90 and Salnave RD N 47 30.3 W117 41.3					
<b>DIV Z</b>	EMS Responders & Capabilities:	AMBO 2 ALS DIV A and Z					
	Equipment Available on Scene:	ALS Gear and Transport					
	Medical Emergency Channel:	Command A/G VMED29					
	ETA for Ambulance to Scene:						
	Air:	10 to 20 minutes					
	Ground:	10 to 20 minutes					
	Ambulance Rendezvous Points	Sta 33 12611 W Melville AMR Post 904 N 47 34.32 W 117 40.98 Sta 311 S Lefevre St Medical Lake City Hall N 47 34.32 W 117 40.98 I-90 and Salnave RD N 47 30.3 W117 41.3					
<b>NIGHT DIV</b>	EMS Responders & Capabilities:	AMBO 1 ALS ALL DIVISIONS STAGED AT DP 80					
	Equipment Available on Scene:	ALS Gear and Transport					
	Medical Emergency Channel:	Command A/G VMED29					
	ETA for Ambulance to Scene:						
	Air:	10 to 20 minutes					
	Ground:	10 to 20 minutes					
	Ambulance Rendezvous Points	Sta 33 12611 W Melville AMR Post 904 N 47 34.32 W 117 40.98 Sta 311 S Lefevre St Medical Lake City Hall N 47 34.32 W 117 40.98 I-90 and Salnave RD N 47 30.3 W117 41.3					
8. Prepared By (Medical Unit Leader)		Date/Time	Reviewed by (Safety Officer)		Date/Time		
/S/ Bill Howell MEDL		8/21/2023	/S/ Eric Brown SOFC		8/21/23		
<b>Identify crew EMT's and Paramedics on the line for each Division prior to engaging. In case of Medical Emergency, notify your supervisor and follow the MEDICAL INCIDENT REPORT "ICS 206" procedure on the back page of the IAP. Call Gray Fire Communications on Command channel to report a Medical Emergency. Minimize radio traffic and maintain situational awareness.</b>							

# MEDICAL PLAN (ICS 206 WF)

Controlled Unclassified Information//Basic

## Medical Incident Report

**FOR A NON-EMERGENCY INCIDENT, WORK THROUGH CHAIN OF COMMAND TO REPORT AND TRANSPORT INJURED PERSONNEL AS NECESSARY.**

**FOR A MEDICAL EMERGENCY: IDENTIFY ON SCENE INCIDENT COMMANDER BY NAME AND POSITION AND ANNOUNCE "MEDICAL EMERGENCY" TO INITIATE RESPONSE FROM IMT COMMUNICATIONS/DISPATCH.**

**Use the following items to communicate situation to communications/dispatch.**

**1. CONTACT COMMUNICATIONS / DISPATCH** (Verify correct frequency prior to starting report)

*Ex: "Communications, Div. Alpha. Stand-by for Emergency Traffic."*

**2. INCIDENT STATUS:** Provide incident summary (including number of patients) and command structure.

*Ex: "Communications, I have a Red priority patient, unconscious, struck by a falling tree. Requesting air ambulance to Forest Road 1 at (Lat./Long.) This will be the Trout Meadow Medical, IC is TFLD Jones. EMT Smith is providing medical care."*

Severity of Emergency / Transport Priority	<input type="checkbox"/> <b>RED / PRIORITY 1 Life or limb threatening injury or illness. Evacuation need is IMMEDIATE</b> <i>Ex: Unconscious, difficulty breathing, bleeding severely, 2° – 3° burns more than 4 palm sizes, heat stroke, disoriented.</i> <input type="checkbox"/> <b>YELLOW / PRIORITY 2 Serious Injury or illness. Evacuation may be DELAYED if necessary.</b> <i>Ex: Significant trauma, unable to walk, 2° – 3° burns not more than 1-3 palm sizes.</i> <input type="checkbox"/> <b>GREEN / PRIORITY 3 Minor Injury or illness. Non-Emergency transport</b> <i>Ex: Sprains, strains, minor heat-related illness.</i>	
Nature of Injury or Illness & Mechanism of Injury		<i>Brief Summary of Injury or Illness (Ex: Unconscious, Struck by Falling Tree)</i>
Transport Request		<i>Air Ambulance / Short Haul/Hoist Ground Ambulance / Other</i>
Patient Location		<i>Descriptive Location &amp; Lat. / Long. (WGS84)</i>
Incident Name		<i>Geographic Name + "Medical" (Ex: Trout Meadow Medical)</i>
On-Scene Incident Commander		<i>Name of on-scene IC of Incident within an Incident (Ex: TFLD Jones)</i>
Patient Care		<i>Name of Care Provider (Ex: EMT Smith)</i>

**3. INITIAL PATIENT ASSESSMENT:** Complete this section for each patient as applicable (start with the most severe patient)

Patient Assessment: See IRPG page 106

Treatment:

**4. TRANSPORT PLAN:**

Evacuation Location (if different): (Descriptive Location (drop point, intersection, etc.) or Lat. / Long.) Patient's ETA to Evacuation Location:

Helispot / Extraction Site Size and Hazards:

**5. ADDITIONAL RESOURCES / EQUIPMENT NEEDS:**

*Example: Paramedic/EMT, Crews, Immobilization Devices, AED, Oxygen, Trauma Bag, IV/Fluid(s), Splints, Rope rescue, Wheeled litter, HAZMAT, Extrication*

**6. COMMUNICATIONS: Identify State Air/Ground EMS Frequencies and Hospital Contacts as applicable**

Function	Channel Name/Number	Receive (RX)	Tone/NAC *	Transmit (TX)	Tone/NAC *
COMMAND					
AIR-TO-GRND					
TACTICAL					

**7. CONTINGENCY: Considerations:** If primary options fail, what actions can be implemented in conjunction with primary evacuation method? Be thinking ahead.

**8. ADDITIONAL INFORMATION:** Updates/Changes, etc.

**REMEMBER:** Confirm ETA's of resources ordered. Act according to your level of training. Be Alert. Keep Calm. Think Clearly. Act Decisively.