

Bulk loading basemaps into Avenza

1. Download zipped files onto your mobile device
 - a. On your phone/Ipad navigate to the FTP website where the basemaps are located:
https://ftp.wildfire.gov/public/incident_specific_data/rocky_mtn/Aviation/Wy_Basemaps/
 - b. Download the zipped file
2. In Device Storage
 - a. Once the zipped file has finished downloading, navigate to the download folder on your device.
 - b. Unzip the zipped file.
3. In Avenza
 - a. Create and name a Collection (using the plus sign button).
 - b. From inside the Collection, import maps (using the plus sign button).
 - c. Navigate to the unzipped maps folder in your device's storage.

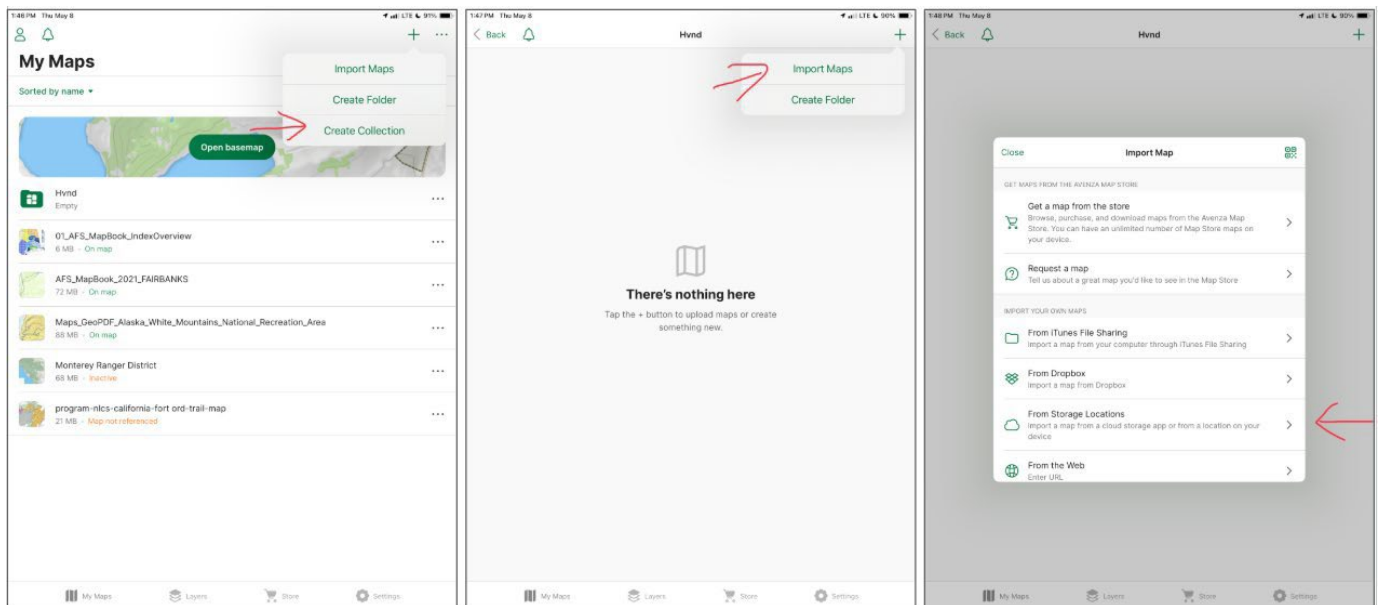

- d. Select all and Open them.
 - i. Select 1 map to activate the Select All option.
 - ii. Maps should begin loading automatically.
 - iii. Avenza may need to stay active and open while loading maps to complete map uploads.

You can now navigate between these basemaps and it will automatically switch to whatever map you are on.