

# UPLOAD A PASSWORD PROTECTED MAP INTO AVENZA

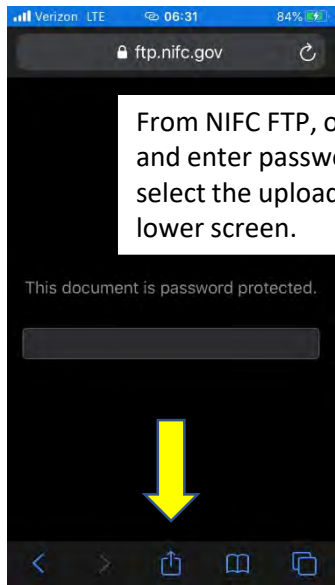

From NIFC FTP, open map and enter password. Next select the upload icon on lower screen.

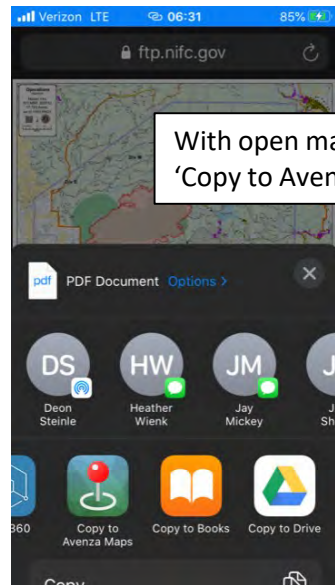

With open map, select 'Copy to Avenza Maps'.

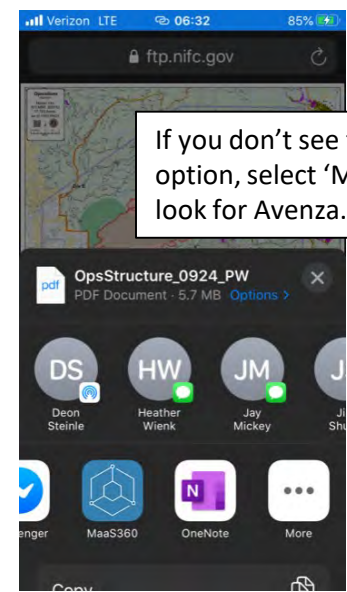

If you don't see the Avenza option, select 'More' and look for Avenza.



You will get this message, push 'OK'.

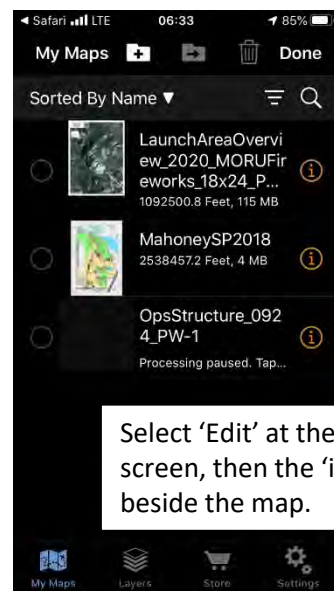

Select 'Edit' at the top of the screen, then the 'i' option beside the map.



Select 'Advanced Options'.

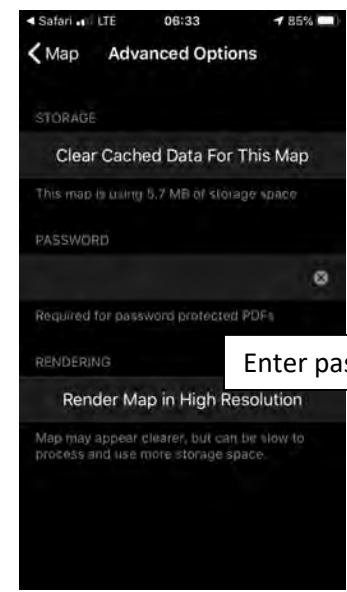

Enter password.



Go back to 'Map', 'Close', then 'Tap to restart'.