

**West Mims Fire**  
**GA-OKR 017006**  
**5/19/2017**  
**Branch I**  
**Operations Map**  
**152,231**  
**Field OPS Acres**  
**5/15/2017 1000 Hrs**

**Div F**  
**Div E**  
**Div D**  
**Branch I**  
**Div C**  
**Div B**  
**Div A**

- Branch Break
- Division Break
- Other
- Aerial Hazard
- Camp
- Dip Site
- Drop Point
- Fire Origin
- Helibase
- Helispot
- Hot Spot
- Incident Command Post
- Mobile Weather Unit
- Pump
- Repeater
- Staging Area
- Water Source
- Structures
- 10 Mile Planning Area
- Uncontrolled Fire Edge
- Escape Route
- Completed Line
- Completed Dozer Line
- Completed Burnout
- Wildfire Daily Fire Perimeter
- Fire Access Road
- Shelters
- Canoe Trail
- Management Action Point
- Refuge Island
- Swamp Edge Break
- Mature Pine Stands
- Reserved Timberlands
- Bethesda State Forest (FL)
- OsceolaNF (USFS)
- Wilderness\_Bndry
- ONWR Bndry
- Other Roads

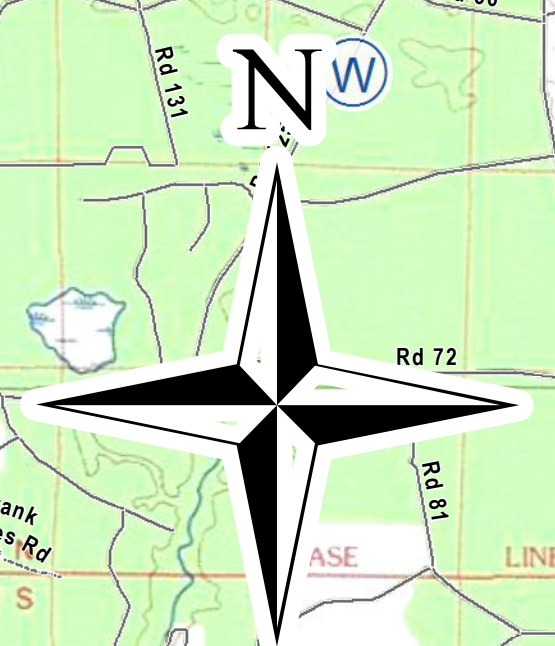

5 0 5  
 Miles  
 Created: 5/18/2017 1833hrs NAD83  
 SA Red Team GIS

