

**Ops - Div M**  
 Black NMCNFO0185  
 5/31/2022  
 249,656 acres as of 5/30/2022 2146 MDT  
 Acres from IR, NAD 1983 2011 Datum, LatLong Grid

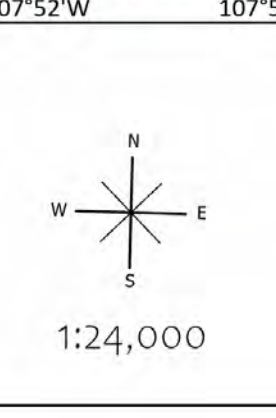

● Dip Site	● Value at Risk	◆ Repeater	□ Pump	— Planned Mixed Construction Line	— Uncontained	— Dirt (Not Paved)	• Buildings	▲ Trailhead	— Wash	□ Federal Wilderness Boundary	■ Reservoir	■ Freshwater Forested/Shrub Wetland	□ Private; Local Government; Undesignated
● Hellsite	● Other	◆ Hazard	□ Water Tank	— National Designated Trail	— National Designated Trail	— Paved Road	▲ TNM Derived Names	— Spring/Seep	— Stream/River; Artificial Path	— State Boundary	□ Township	■ Forest Service Land	□ World Hillshade
● Sling Site	● Gate	◆ Wildfire Daily Fire Perimeter	— Completed Dozer Line	— Planned Road as Line	— Trail	— Dirt Roads	▲ Summit; Gap	— Waterfall	— Stream/River Intermittent	— County Boundary	□ Section	■ Scenic Byway	□ Federal Wilderness Boundary
● Division Break	● Water Development or Draft Site	● Mines	— Completed Hand Line	— Planned Secondary Line	— National Designated Trail	— Unimproved Roads	▲ FS Common Unit Names	— Well	— Proclaimed FS Boundary	— County Subdivision Boundary	□ Normal Index	■ Scenic Byway	□ Other State Lands
● Incident Command Post	● Fence - Cut/Damaged	◆ Utility Lines	— Planned Dozer Line	— Temporary Flight Restriction	— Secondary Highway	— Closed Roads	▲ GNIS Populated Places Some	— Nonreathen Shore	— Administrative FS Boundary	■ Lake / Pond	□ Normal Intermediate	■ Bureau of Land Management Lands	□ Ranger District Boundary
● Drop Point	◆ Internet Access	◆ Contained	— FireHistory		— Paved Roads			— Ranger District Boundary	— Lake / Pond (Intermittent)	■ Freshwater Emergent Wetland			

**SOUTHWEST AREA**  
 INCIDENT MANAGEMENT TEAM 3