

Div F/K

Div A

Div M/O

Div S

Operations

Black
 NMGNF00185
 5/31/2022
 249,656 acres as of 5/30/2022 2146 MDT
 Acres from IR
 North American 1983 Datum, Loll Long Grid

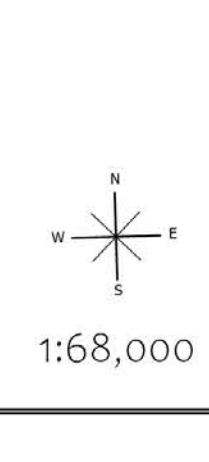

<ul style="list-style-type: none"> Dip Site Helipad Strip Site Division Break Incident Command Post Drop Point Camp Value at Risk Other Gate 	<ul style="list-style-type: none"> Water Development or Draft Site Hazard Tree Fence - Cut/Damaged Mobile Weather Unit Internet Access Safety Zone Hazard Water Source 	<ul style="list-style-type: none"> Wildfire Daily Fire Perimeter Label Point Completed Doser Line Completed Hand Line Completed Mixed Construction Line Completed Road on Line Planned Doser Line Planned Hand Line 	<ul style="list-style-type: none"> IR Scattered Heat National Designated Trail Trail National Designated Trail National Designated Trail 2013 Silver Fire Other Planned Flight Restriction Controlled DIH (Hot Power) Paved Road Gravel Road DIH Roads Unimproved Roads Crossed Roads Trail National Designated Trail National Designated Trail 2013 Silver Fire Other THM Designated Names Summit Cap FS Common Unit Names GNIS Populated Places Some 	<ul style="list-style-type: none"> Waterfall Nonwater Shore Wash Stream/River, Artificial Path Canal/Ditch Stream/River Intermittent Incorporated FS Boundary Administrative FS Boundary Ranger District Boundary Well State Boundary County Subdivision Boundary Lake/Pond Lake/Pond (Intermittent) Township Proprietary Section Section Waterfall Nonwater Shore Wash Stream/River, Artificial Path Canal/Ditch Stream/River Intermittent Incorporated FS Boundary Administrative FS Boundary Ranger District Boundary 	<ul style="list-style-type: none"> Depression Index Depression Intermediate Normal Index Normal Intermediate Freshwater Emergent Wetland Freshwater Forested/Shrub Wetland Freshwater Pond Tubuley Scenic Byway State Public Lands Other State Lands Bureau of Land Management Lands Private Local Government/Undesignated Forest Service Land World Hillside Federal Wilderness Boundary
--	--	---	--	--	---

SOUTHWEST AREA

INCIDENT MANAGEMENT TEAM 3