

# Ops - Div A

Black MNGNF00185  
6/3/2022  
364,657 acres at 6/2/22 10:23 MDT  
Aces from IR\_NAD 1983 2011 Datum, LatLong Grid

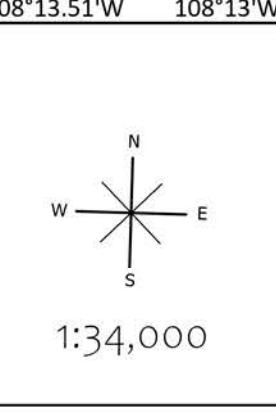

<ul style="list-style-type: none"> <li>Dip Site</li> <li>Helispot</li> <li>Division Break</li> <li>Drop Point</li> <li>Value at Risk</li> <li>Water Development or Draft Site</li> </ul>	<ul style="list-style-type: none"> <li>Repair Point</li> <li>Hazard Tree</li> <li>Internet Access</li> <li>Safety Zone</li> <li>Wildfire Daily Fire Perimeter</li> <li>Mines</li> </ul>	<ul style="list-style-type: none"> <li>Utility Lines</li> <li>Water Tank</li> <li>Completed Dozer Line</li> <li>Completed Hand Line</li> <li>Completed Mixed Construction Line</li> <li>Completed Road as Line</li> <li>Planned Dozer Line</li> <li>Planned Hand Line</li> <li>Planned Road as Line</li> <li>Temporary Flight Restriction</li> <li>Contained</li> </ul>	<ul style="list-style-type: none"> <li>Uncontained</li> <li>IR Heat Perimeter</li> <li>IR Intense Heat</li> <li>IR Scattered Heat</li> <li>National Designated Trail</li> <li>Trail</li> </ul>	<ul style="list-style-type: none"> <li>National Designated Trail</li> <li>Gravel Road</li> <li>Dirt Roads</li> <li>Unimproved Roads</li> <li>Closed Roads</li> <li>Dirt (Not Paved)</li> <li>Paved Road</li> </ul>	<ul style="list-style-type: none"> <li>Buildings</li> <li>TNM Derived Names</li> <li>Summit; Gap</li> <li>FS Common Unit Names</li> <li>GNIS Populated Places Some</li> <li>Campground</li> <li>Trailhead</li> <li>Interpretive Site</li> <li>Spring/Seep</li> <li>Waterfall</li> <li>Well</li> <li>Nonearthen Shore</li> <li>Stream/River; Artificial Path</li> <li>Stream/River Intermittent</li> <li>Proclaimed FS Boundary</li> <li>Administrative FS Boundary</li> </ul>	<ul style="list-style-type: none"> <li>Ranger District Boundary</li> <li>Federal Wilderness Boundary</li> <li>Other Designated Boundary</li> <li>State Boundary</li> <li>County Boundary</li> <li>County Subdivision Boundary</li> <li>Lake / Pond</li> <li>Lake / Pond (Intermittent)</li> <li>Normal Intermediate</li> <li>Freshwater Emergent Wetland</li> <li>Freshwater Forested/Shrub Wetland</li> <li>Freshwater Pond</li> <li>Depression Intermediate</li> <li>Normal Index</li> <li>Revesoir</li> <li>Township</li> <li>Protracted Section</li> <li>Section</li> </ul>	<ul style="list-style-type: none"> <li>Tollway</li> <li>Scenic Byway</li> <li>State Public Lands</li> <li>National Park Service Lands</li> <li>Forest Service Land</li> <li>World Hillshade</li> <li>Federal Wilderness Boundary</li> </ul>
--	---	---	--	--	---	---	---

**SOUTHWEST AREA**  
INCIDENT MANAGEMENT TEAM 3