

Evacuation Black

NMCGN000185
6/11/2022 Day
304,550 acres as 6/11/2022 0100 MDT from IR

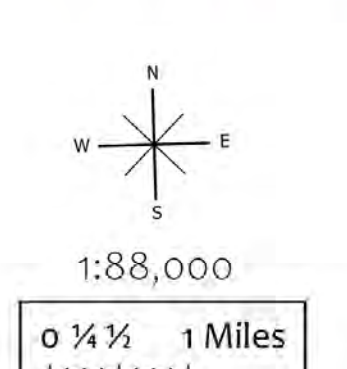

- | | | | | | |
|------------------|-------------------|---------------------------|-----------------------------|---------------------------------|---|
| Fire Perimeter | Trailhead | National Designated Trail | Paved Road | Forest Service Land | Private, Local Government, Undesignated |
| Contained | Picnic Site | State Public Lands | Gravel Road | Other State Lands | Planning |
| Uncountained | Group Picnic Site | Primary Highway | Dirt Road | Bureau of Land Management Lands | Ready |
| Division Break | Boating Site | Secondary Highway | Unimproved Roads | National Park Service Lands | Set |
| Campground | Interpretive Site | Paved Roads | Closed Roads | County Boundary | Go |
| Group Campground | | Dirt (Not Paved) | National Park Service Lands | | |

- Evacuation Areas**
- Planning
 - Ready
 - Set
 - Go

- NM911 Address Points**
- Address Points

Every effort has been made to provide accurate and useful information. For the latest information on evacuation status for the Black Fire look here: <https://tinyurl.com/interactiveEvacuationMap>.



Evacuation Web Map